

systems integrationasia

AUDIO | VISUAL | CONTROL | COLLABORATION | UNIFIED COMMS

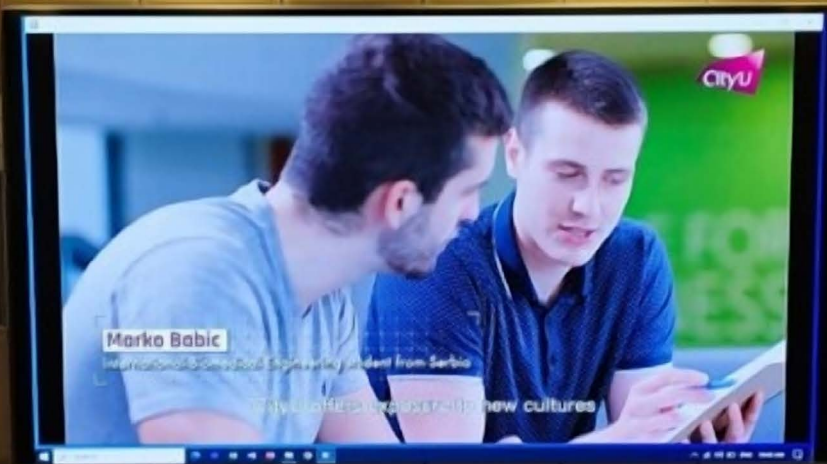

THE FAMED MULTIMEDIA ROOM AT CITY UNIVERSITY OF HONG KONG WITNESSES A TECHNOLOGICAL RENAISSANCE



Commentary:
"Everything Has Changed"
Joe Pham, Chairman & CEO,
QSC

Interview:
Seizing the Future - HDC LED
Display Asia









Solution Highlight:
Datapath's Aetria Offers
Scalable and Future-proof
Solution



Acclaim V3 Series

Exploring infinite possibilities

A2712 V3 | A2715 V3 | A2719 V3 | A2725 V3

-  **16:9**
Aspect ratio
-  **HDR10 (Optional)**
Image processing technology
-  **4500:1**
High contrast ratio
-  **Wide viewing angle**
No color cast
-  **16bit**
High grayscale
-  **APS energy-saving technology**
High efficiency and energy saving
-  **Overcurrent protection**
For safe and reliable display
-  **Precision floating connector**
Bright and dark lines adjustment

Application Scenarios



Entrance & Lobby



Exhibition Hall



Conference Hall



Flagship Stores

Email: absenasi@absen.com

Website: www.absen.com



Scan for more

CONTENTS

Volume 22 Issue 11: NOVEMBER 2023



56 INSTALLATION Anolis for Stunning Maiden's Tower Installation

04 FIRST WORDS

COMMENTARY

06 "Everything Has Changed"

INTERVIEW

08 Seizing the Future: HDC LED Display Asia's Quest for LED Display Market Share

SPECIAL FEATURE

10 ISE 2024 to Highlight the Best in Pro AV at its Biggest Event Yet

14 NEWS

SOLUTION HIGHLIGHT

34 Aetria – Datapath's Scalable and Future-proof Solution that is Fitting for the Modern Control Room

37 SOLUTIONS UPDATE

INSTALLATION

53 From Classroom to Future-Ready Teaching Laboratory -Education University of Hong Kong

60 City University of Hong Kong - From Analog to AVOIP

“

Imagine collaboration spaces that anticipate your needs, educational environments that empower students, sports bars that transport you to the heart of the action, hotels that offer personalized and unforgettable stays, theme parks that blur the line between fantasy and reality, and entertainment that resonates on a profound level. This is what the AV industry, powered by AI and data, can achieve.

Joe Pham, Chairman & CEO, QSC

”

To read more go to our Feature on page 6



In this issue, we are excited to feature an insightful presentation by Joe Pham, Chairman & CEO of QSC, which he delivered at InfoComm 2023. Joe's visionary perspective on the industry's trajectory always makes for compelling reading. The remarkable evolution of QSC, transitioning from a traditional amplifier company to its current state, is a testament to Joe's forward-thinking leadership. We trust that you'll find his thoughts as inspiring as we did. Turning to our installation column, we showcase the innovative initiatives undertaken by two universities in Hong Kong. Both institutions have embarked on the journey of creating interactive, future-ready spaces. We invite you to delve into their stories and enjoy the read.



Thomas Richard Prakasam
Publisher/Editorial Director
thomas@spinworkz.com



EDITOR, INDIA AND ME
Ram Bhavanashi
ram@spinworkz.com



FEATURES EDITOR
Elton Noronha
elton@spinworkz.com



ADVISOR
David Lim
davidlim@spinworkz.com



ADMIN & CIRCULATION
Julie Tan
admin@spinworkz.com



MEDIA REP CHINA, HONG KONG, TAIWAN
Judy Wang
Worldwide Focus Media
+86-13810325171
judywang2000@vip.126.com



DESIGN & LAYOUT
Hazel Gundaya

PUBLISHED BY

Spinworkz Pte Ltd
71 Bukit Batok Crescent
#06-13 Prestige Centre
Singapore 658071
Tel: (65) 63162716

Disclaimer: Systems Integration Asia is published 12 times a year. All rights reserved. No part of this magazine is to be reproduced, whether mechanical or electronic without the prior written consent of the publisher. Views expressed in this magazine do not necessarily reflect those of the editor or the publisher. Unsolicited contributions are welcome but the editor reserves the discretion to use them. Whilst every care is taken to ensure the accuracy and honesty in both editorial and advertising content at press time, the publisher will not be liable for any inaccuracies.

Please be informed that products and company names mentioned in this publication may be protected with tradenames, trademarks or registered trademarks of their respective owners. Our non inclusion of such symbols is not an indication of us not recognising the copyright but rather to have a common look across our articles. Misuse of tradenames, trademarks or registered trademarks is strictly prohibited. It is the obligation of our readers to check if company names and products are protected with tradenames, trademarks or registered trademarks.

EPSON



AN IMMERSIVE EXPERIENCE LIKE NO OTHER

Epson High Brightness Laser Projectors

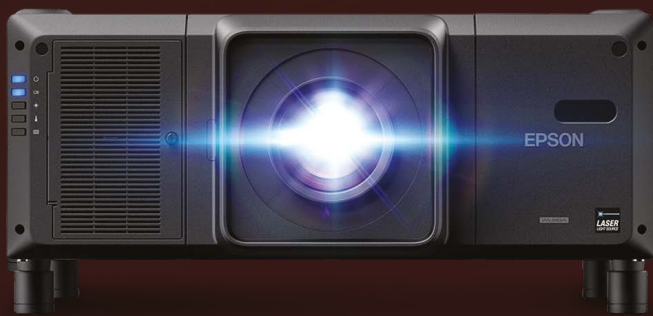

3X brighter[^] colours with 3LCD technology

Brightness of up to 30,000 lumens

Uninterrupted projection for up to 20,000 hours*

Epson is the registered trademark of Seiko Epson Corporation, Japan.



Epson Helpline: For product info or service - 1800 425 0011
For service - 1800 123 001 600 or 1860 3000 1600 (9 am - 6 pm) (Mon - Sat)

www.epson.co.in

*Source: Futuresource Consulting. [^]Colour brightness (colour light output) in brightest mode, measured by a third-party lab in accordance with IDMS 15.4. Colour brightness will vary depending on usage conditions. Top-selling Epson 3LCD projectors versus top-selling 1-chip DLP projectors based on NPD sales data for May 2017 – April 2018. *3 years or 20,000 hours, whichever is earlier.

“Everything Has Changed”

by Joe Pham, Chairman & CEO, QSC

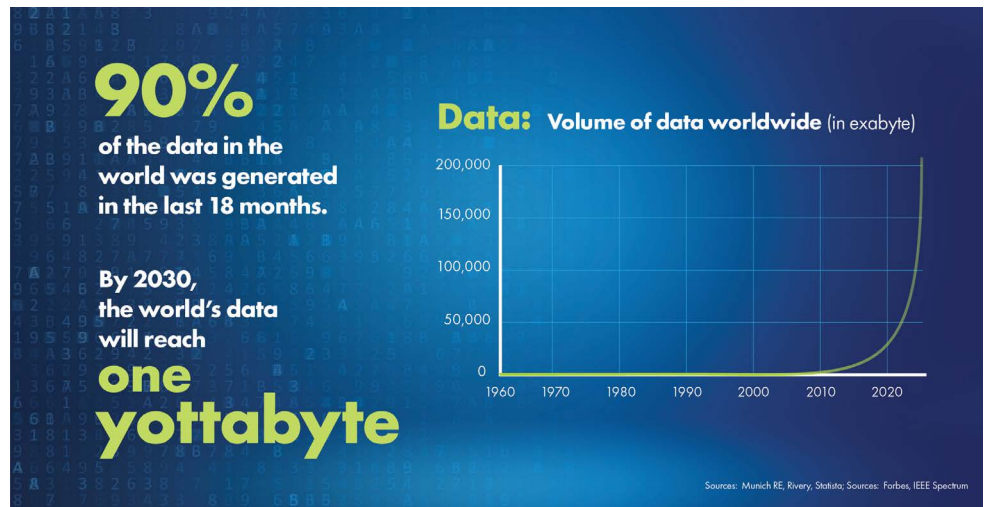

How Did We Get Here?

Humanity is at an inflection point, where technology is advancing at an unprecedented rate. As I witness this era of exponential change throughout the AV industry, sometimes I ask myself ‘how did we get here’? Just like fire transformed our ancestors' lives, just as the internet reshaped my daughter's upbringing, we now stand on the cusp of a new era, one where AI and AV converge can and will redefine our world. As we venture into this transformative era, the AV industry is no longer the silent supporting act; it's poised to take the spotlight in bridging the chasms of human connection.

We thrive on communication, the sharing of experiences, and the warmth of human interaction. It is here that the AV industry emerges as a beacon of hope, possessing the power to amplify our most essential senses for connection – sight and sound.

Enterprises recognize the value of engaged workforces. Collaboration and communication are not merely options; they are the lifeblood of modern

organizations. It's about more than just displaying content; it's about fostering engagement, enhancing productivity, and elevating experiences.

The current demand for personalized and immersive interactions is insatiable. This is where the AV industry provides the power to harness technology for human connection. It's about taking data and turning it into valuable insights, shaping the AV industry across various domains.

What do We Need to do?

1. Adaptation and Evolution: To realize this vision, we must pivot from a hardware-centric approach to a versatile, agile, and software-driven architecture. This transition will enable the creation of digital twins for AV systems, streamlining design and deployment on a grand scale.

2. Ecosystem-Based Smart Building: We must construct ecosystems around software platforms that encompass hardware, applications, creators, and

New Tech Adoption

30% of global companies started using video conferencing for the first time

5 yrs Remote work forced organizations to bring forward digital business transformation plans by at least 5 years

71% of people globally say that advanced technologies like video cameras, data analytics, cyber security, and cloud are needed to address modern business challenges

Sources: Gartner, Motorola Survey

systems of systems. This holistic approach allows us to offer comprehensive AV solutions that cater to diverse industry needs.

3. Transformation with AI and Data: Audio AI that immerses us further in communication, predictive analytics that enhance user experiences, computer vision that opens new realms of content delivery, machine learning that adapts systems to user preferences, and generative AI that sparks creativity. These technologies as tools that can enhance the capabilities of AV systems, making them more intuitive, predictive, and adaptive to user needs.

Imagine collaboration spaces that anticipate your needs, educational environments that empower students, sports bars that transport you to the heart of the action, hotels that offer personalized and unforgettable stays, theme parks that blur the line between fantasy and reality, and entertainment that resonates on a profound level. This is what the AV industry, powered by AI and data, can achieve.

The Question Remains: Will We Seize the Moment?

In an era defined by exponential change, the AV industry stands at the vanguard of transformation and innovation. We can create experiences that resonate deeply and forge connections that endure. The time has come to grasp this opportunity, to embrace the transformative power of AI and AV, and to shape a future where human connection is more profound than ever before.

Consider cautionary tales like Blockbuster Video or Kodak: huge industry leaders in their prime that chose to ignore the exponential change surrounding them until it was simply too late, giving way to fearless trailblazers. We must acknowledge our duty in AV and take an active role in crafting our own storyline, or risk having it being written by others.

QSC

Q-SYS

Seizing the Future: HDC LED Display Asia's Quest for LED Display Market Share



In July 2023, HDC LED Display Asia Pte Ltd celebrated its grand opening with a captivating blend of innovation and inspiration. This state-of-the-art office, housing an immersive experience

centre, is a testament to the limitless potential of LED technology. HDC LED Display stands as a beacon of customization, delivering tailored LED solutions from its global hub in Shanghai. Fuelled by the relentless progress of LED technology and the burgeoning economies of Southeast Asia, the company has strategically established its inaugural regional office in Singapore. SI Asia sits down with **Henry Ho**, the **General Manager**, to uncover HDC LED Display's ambitious roadmap for the future.

What motivated the establishing of HDC LED Display Asia Pte Ltd? What are its objectives?

The motivation came after seeing how rapidly the growth of LED display markets went from 2018 onwards. It was also at the same time that Simon Lim, Managing Director of HDC, saw the pace of this technology maturing and expansion of R&D to push the boundaries of LED technology beyond SMDs. Fast forward to today, many would reconcile that the LED display technology has reach an acceptable level in terms of image quality, consistency and affordability for businesses.

The primary objective for HDC LED Display Asia Pte Ltd being established is to deepen its presence in the region with a base in Singapore out from its Shanghai headquarters, to serve the market with creative imaging solutions. Emerging Asia markets have put up a strong performance in the last few years leading up to the pandemic and GDP growth remained robust despite the recent turmoil. The growth projection post rebound is looking robust and that prompted the birth of HDC LED Asia Pte Ltd.

Who are the key appointment holders?

The company is made-up of three key stakeholders that form the supporting structure to drive the market in Asia for HDC.



Simon Lim with Mr Fang from the Shanghai manufacturing office at the grand opening.

Simon Lim , Managing Director, who boasts over two decades of experience in the AV Industry, with a humble start in AV sales and eventually diverted to an installation business which he ventured in Singapore. He witnessed the industry transformation, bolstered by a strong confidence of where the market is at today. This prompted him to invest in a partnership with a LED manufacturer to expand the market share and capture the diverse market vertical.



Edward Chia - Regional Sales Director, with over two decades of experience in the AV industry. His diversity of experience prior to joining HDC was with a global MNC responsible for brand management and product

marketing. Prior to that, he was serving the AV market as Pre-Sales Consultant and under him he has a belt of projects that he won, which was designed by him in hospitality, entertainment, corporate and education market.

Henry Ho, General Manager, also with nearly two decades of experience in the AV industry has served various roles from professional audio manufacturer, AV consultancy and in a global system integration company.

Is HDC representing any brands and if yes, please can you give the details?

HDC LED Display Asia Pte Ltd operates as a direct manufacturer with a strong collaboration back to it's headquarter and manufacturing plant. In addition to the HDC LED displays brand, HDC is appointed as the regional distributor for **Colorlight Cloud Tech**. The company is still reviewing other partnerships but there

has been a few approaches also with audio companies that can strengthen both companies in terms of market approach.

What expertise and services is HDC providing?

As a manufacturer, the goal is to built-up a strong network and HDC LED Display Asia Pte Ltd aims to upskills the partners from system integrators to distributors with the necessary skillset in designing and selling. Beyond that, our speciality is in LED customization to visually enhance customer experience. We have solutions to form 3D displays in odd shapes beyond the typical 2D flat layouts. In addition to that, we have an in-house service support for repairs and offer maintenance contracts for HDC customers.

Is the company providing its services beyond Singapore?

While our primary focus is on establishing an Asia HQ in Singapore, we are actively reaching out to the Asian region and its local contacts to expand HDC's presence, products, service, and support.

HDC LED Display Asia

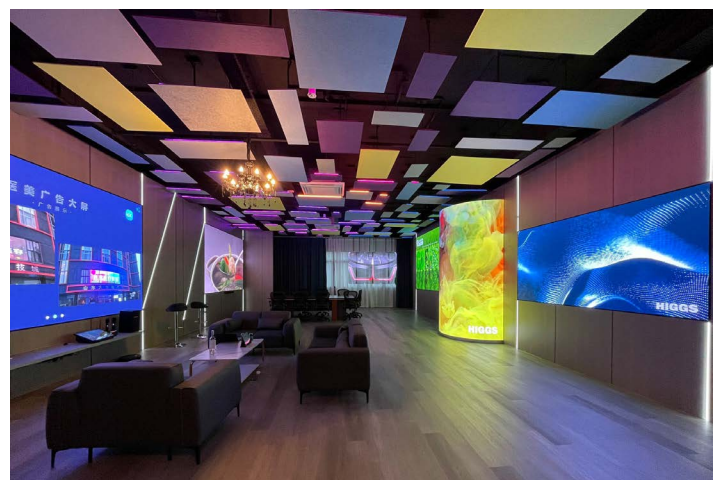

HDC LED Display Asia office Showroom.



ISE 2024 to Highlight the Best in Pro AV at its Biggest Event Yet

ISE 2024 takes place at the Fira Barcelona Gran Via from 30 Jan – 2 Feb 2024. This special 20th anniversary edition is set to be the biggest yet, as ISE celebrates two decades of pro AV and systems integration excellence



Since it began in 2004, Integrated Systems Europe (ISE) - the world's premier exhibition for professional audio visual (pro AV) and systems integration - has grown in size, strength and influence to become an industry-defining event. Every year, ISE brings together professionals, innovators and thought leaders across multiple industry sectors from around the world.

Celebrating 20 Years of Innovation

Recognised as the world's leading AV and systems integration exhibition, ISE's journey from its humble beginnings in Geneva, to becoming the definitive event it is today has been a remarkable success story. Over the past two decades, ISE has served as a catalyst for groundbreaking technological advances, fostered meaningful connections and dialogue and propelled the systems integration industry to new heights.



“This special 20th anniversary edition of ISE will be our biggest ever event, with an expanded show floor which is already 17% bigger than last year, two new halls, over 80 new exhibitors currently confirmed and several special features and attractions to mark the occasion, including an Anniversary Treasure Hunt. We also are planning a number of special activities throughout Barcelona, including extending our partnership with the Barcelona Llum lighting festival – watch out for more news in the coming weeks,” said Mike Blackman, Managing Director at Integrated Systems Events.

Seven Technology Zones & New Halls

New for 2024, ISE has grown into Halls 1 and 4 of the Fira Barcelona Gran Vía. Hall 1 becomes the new home of Lighting & Staging, while Hall 4 provides a new location for Content Production & Distribution while also allowing the Multi-Technology Zone to be extended.

The show floor is easy to navigate, set out across seven Technology Zones to provide visitors with the full spectrum of pro AV and systems integration required for every event and installation:

- **Lighting & Stage Hall** (Hall 1)
- **Residential & Smart Building** (Hall 2)
- **Unified Communications & Education Technology** (Hall 2)
- Multi-Technology (Halls 3, 4 & 5)
- **Content Production & Distribution** (Hall 4)
- **Digital Signage & Dooh** (Hall 6)
- **Audio** (Hall 7)
- Plus ISE Sound Experience with Audio Demo Rooms in Hall 8.0

Conference Programme

Building knowledge and upskilling has never been more important for AV professionals. ISE’s informative conference programme is designed to inspire and equip attendees with the information and tools required to lead an organisation. It’s also a great opportunity to network with the people and companies redefining the global AV industry.

With nine specialist conferences taking place during the show, visitors can enjoy a host of immersive demonstrations, insightful speakers and inspiring

panel discussions. There will also be free-to-attend sessions taking place throughout the day at ISE, running concurrently with the conferences.

Bookable Conferences:

- Smart Building Conference (Tuesday 30 January)
- Control Rooms Summit (Tuesday 30 January)
- Smart Home Technology Conference (Tuesday 30 January – Friday 2 February)
- Content Production & Distribution Summit (Wednesday 31 January)
- Digital Signage Summit (Wednesday 31 January)
- Smart Workplace Summit (Wednesday 31 January – Thursday 1 February)
- Education Technology Summit (Thursday 1 February)
- Live Events Summit (Thursday 1 February)
- Sustainability Workshop (Friday 2 February)

Free-to-Attend Sessions:

- Tech Talks Español (Tuesday 30 January – Thursday 1 February)
- Tech Talks (Tuesday 30 January – Thursday 1 February)
- Smart Home Technology Stage (Tuesday 30 January – Friday 2 February)

Barcelona LLUM Festival

Away from the show floor, take the opportunity to explore the beautiful city of Barcelona in a completely different way at Llum BCN, festival of the light arts, sponsored by ISE. Head out after dark in the urban



Poblenou neighbourhood as it is transformed with light projections, installations, and light sculptures by contemporary artists.

Don't miss the biggest ISE yet!

Readers can secure FREE registration for ISE 2024 using this code: systemsintasia

Registration for ISE 2024 is open now. Visit www.iseurope.org to sign up for updates, alternatively, keep up to date via our social media:

Instagram: @ise_show

LinkedIn: @Integrated Systems Europe (ISE)

X: @ISE_Show

Facebook: @Integrated Systems Europe



Power to the speaker. Power to the integrator.

Our Smart IP loudspeakers combine exceptional sound quality with single cable convenience. With PoE, AES67 and Dante compatibility plus sophisticated loudspeaker management all supported via a standard CAT cable, Smart IP enables you to deliver class-leading audio, while saving you time and money.

Learn more at [genelec.com/smart-ip](https://www.genelec.com/smart-ip)

GENELEC®



The D4K40-RGB projector fitted in the giant-screen theatre has enhanced the viewing experience.

Christie RGB Pure Laser Projectors Illuminate Mogao Grottoes Digital Exhibition Center

CHINA: Christie is pleased to announce that its high-performance RGB pure laser projectors are illuminating several giant-screen and dome theatres with magnificent visuals that accentuate the splendour of the world-famous Mogao Grottoes.

Located within the expansive Mogao Grottoes Digital Exhibition Center in China's northwestern Gansu province, this facility is home to four digital theatres,

including two giant-screen theatres and two dome theatres. In these venues, visitors can delve into the rich history, culture, preservation efforts, and scholarly research of the Mogao Grottoes – a UNESCO World Heritage Site – through high-definition documentary films presented in stunning 8K resolution by the Dunhuang Research Academy.

The four digital theatres, which have been operating for a decade, recently underwent a significant transformation. This overhaul included upgrading the projection systems to Christie's state-of-the-art **D4K40-RGB** pure laser projectors that push the boundaries of brightness, colour reproduction, image uniformity, installation versatility, and operational lifetime. The results are unparalleled onscreen visuals that significantly elevate the viewing experience with the most vibrant images and purest colours.

INFILED

Screen your dreams

CBSF TECH

**Color accuracy, brightness,
avoiding color shifts**

Designed for Virtual Production

www.infiled.com info@infiled.com

Christie's trusted partner, **Beijing Huayi Shengshi Technology**, installed 14 D4K40-RGB projectors. Six projectors were meticulously installed in each dome theatre, which boasts an impressive 18-meter (59-foot) diameter and seating for 200 spectators. In addition, a D4K40-RGB projector had been strategically fitted in each of the giant-screen theatres, featuring a 14.7-meter (48-foot) screen length and towering 6.2-meter (20-foot) height.



Highly immersive visuals by Christie D4K40-RGB pure laser projectors in the dome theatres.

"The Mogao Grottoes stand as an unparalleled repository of global Buddhist art, housing the world's largest collection of such invaluable treasures," said Hailong Wang, project manager of Huayi Shengshi Technology. "Dunhuang Research Academy's efforts to showcase these precious artifacts through high-definition documentary films in these upgraded digital theatres are highly commendable. We are honoured to have played a pivotal role in this transformative project, dedicated to enhancing the visitor experience and sharing these historical treasures with a global audience."

The D4K40-RGB pure laser projectors were chosen for their remarkable features, such as high brightness, true-to-life colours, long-lasting RGB

pure laser illumination, minimal consumables, and ease of long-term maintenance. The installation and commissioning of these projectors took five months due to complex aspects of the project, including secondary site modifications, demolition, and reconstruction. Supporting facilities were also upgraded to optimize projector performance.

"The projection results have exceeded our expectations, and the client is pleased with the exceptional image quality and overall performance of the D4K40-RGB projectors," Wang remarked. "Upgrading to RGB pure laser projection has elevated the visual experience to a whole new level, validating the successful accomplishment of this major refurbishment project."

April Qin, senior sales director for China, Enterprise, Christie, added, "This project exemplifies Christie's commitment to providing advanced and reliable projection solutions that enhance audience experiences in culturally significant venues. The giant-screen and dome theatres at the Mogao Grottoes Digital Exhibition Center are integral to the conservation, management, and research of the Mogao Grottoes, and Christie takes pride in contributing to their continued significance."

Featuring an all-in-one, compact design, the D4K40-RGB boasts a reliable light source with 20,000 hours of illumination performance for uninterrupted visuals. It also has an expanded colour gamut that produces over 95 per cent of Rec. 2020, offering rich, vibrant, true-to-life visuals. Additionally, the D4K40-RGB offers unparalleled installation flexibility with omnidirectional capabilities. Energy-efficient and equipped with Christie TruLife electronics, it's at the forefront of high-brightness RGB pure laser projection technology.

Christie



SENNHEISER

TEAMCONNECT CEILING MEDIUM

Be heard in the room – everywhere.

With a coverage of up to 40 m², our ceiling microphone TeamConnect Ceiling Medium is the right choice for mid-sized meeting rooms and lecture or collaboration spaces.

www.sennheiser.com/tccm



NEW

5 YEAR WARRANTY
German Engineering

For more information contact us at info@sennheiser.com



Alfalite Takes its LED Display Technology to the Senate of Pakistan

PAKISTAN: Alfalite, the only European manufacturer of LED screens, is pleased to announce its first project in Pakistan by the hand of its distributor **World Wide Vision**. The Senate of the Asian country has installed two 5 x 3 metre screens of the Alfalite Modularpix Pro 1.9 model with ORIM technology.

The project was developed by the brand's local dealer, World Wide Vision, based in Islamabad, who is certified and trained by Alfalite to carry out the installations of the manufacturer's LED screens.

The two displays, each with a resolution of 2560 x 1536 pixels, have a total of 120 Alfalite Modularpix Pro



1.9 LED panels and have been mounted on the plenary walls. The displays are managed by two Novastar VX1000 all-in-one controllers, also supplied by World Wide Vision.

Luis Garrido, executive director of Alfalite, says: "We are very happy with this first installation in Pakistan and would like to congratulate our partner World Wide Vision for their excellent work in integrating our screens in the country's Senate."

In turn, Huzaifa Mustafa, technical director of World Wide Vision, says: "We are very pleased to have completed our first project with Alfalite in an environment as emblematic and demanding as the Senate. Working with Alfalite's European-made screens gives us great confidence for our clients, in addition to the excellent image quality they offer and the peace of mind that they feature ORIM technology, which makes them particularly robust."

ORIM (Optical Resin Injection Module) technology is a new LED panel termination system using optical resin

injection that improves precision between modules (<0.5 mm). In addition, it provides an extended horizontal and vertical viewing angle of 175 degrees. LED panels with ORIM technology have superior antistatic protection (ESD > 10kV), better heat dissipation parameters and excellent resistance to impact, liquids, chemicals, and fire (UL94 standard). In addition, they are easier to clean, suffer less deterioration and have the shortest repair time on the market.

Alfalite

MG Series AV Over IP System

MG Series AV over IP system is a distributed management and control system based on network, nodes and digitization.

The system utilizing low bandwidth, providing low-latency and lossless audio and video experience, breaking the limitations of the traditional centralized deployment mode. It is suitable for decentralized deployment of audio and video interconnection applications across floors, regions and networks. The system integrates audio and video long-distance digital transmission, signal switching, KVM and screen management.

- Low Latency with High Image Quality
- Industry-leading Nanosecond Synchronization
- Exclusivity All-in-One Highly Integrated
- High Reliability
- Secure system with Decentralized
- Diversified Displays Supported



NOVA STAR

WWW.NOVASTAR.TECH

✉ zachary@novastar.tech



PRESS RELEASE

HDBaseT-USB3: Professional Grade USB3.2 Extension



HDBaseT Alliance to Standardise High-Performance USB 3.2 Extension

INTERNATIONAL: The HDBaseT Alliance, Professional AV's largest interoperable ecosystem, is poised to revolutionise the industry once again with the ratification and standardisation of long-reach extension of USB 3.2 connectivity. The pioneering effort addresses critical industry challenges by providing a professional-grade replacement to existing extension solutions that fall short with respect to cost, power consumption, distance, field-termination, stability, and support for all USB 3.2 data transfer types.

The new HDBaseT-USB3 standard is set to be implemented as an ASIC solution soon and will empower AV manufacturers for the first time ever to natively embed long-reach USB 3.2 and power extension into their products, ensuring high performance and reliable connectivity for up to 100m/328ft over standard, field-terminated, Category cable, at a significantly lower power, size, and cost.

Additionally, the HDBaseT Alliance is committed to supporting the adoption of this ground-breaking technology through a comprehensive Certification Program, guaranteeing interoperability of devices irrespective of manufacturer.

Effi Goldstein, president of the HDBaseT Alliance, expressed excitement for the new development, stating, "What HDBaseT did for HDMI extension, we are now poised to replicate for USB 3.2. We are proud to offer a reliable and Professional-Grade extension standard with unparalleled performance and flexibility. USB 3.2 has rapidly become the go-to interface for devices commonly used in video conferencing, as well as in the medical, and industrial fields as evidenced by the proliferation of cameras and other USB-based peripherals that up until now required costly, inflexible, proprietary external FPGA or fibre-based solutions to extend them."

The HDBaseT Alliance is gearing up to unveil the first demonstrations leveraging this innovative standard at the upcoming Integrated Systems Europe 2024 event in Barcelona, marking yet another significant milestone in the world of Professional Audiovisual connectivity.

HDBaseT Alliance

The Stars Align



Meet the High End Systems Hyperstar, a new, sensational companion to Lonestar. A powerful, compact moving light optimized for projection versatility, Hyperstar can help create uniquely beautiful designs, bringing precision and power to every stage. Hyperstar is the same size as Lonestar, and is just as bright, compact, and even more affordable.

Designers have an endless choice of breakups, aerals, radial patterns, and gobos specializing in morphing and texture. And by layering Hyperstar's effects, an endless array of custom visuals are available to achieve your desired look.



Electro-Voice and Dynacord Enhance the Ultimate Coffee Experience at Harudot Chonburi

THAILAND: Located in Chon Buri Province, Thailand, Harudot Chonburi is the latest addition to the Nana Coffee Roasters portfolio of premium coffee houses, and it is truly a coffee house like no other. Carefully crafted beverages, baked goods and gourmet brunches are served to guests in a bright, elegantly designed environment in which modern architecture, nature, food and drink blend together for an unforgettable experience.

In addition to the waves of wood panelling and natural light features, audio plays a key role in creating the right ambience at Harudot Chonburi. A selection of Electro-Voice compact loudspeaker models was chosen in formats and finishes to compliment the aesthetics of the shop's service, dining and meeting



areas. Superior intelligibility at lower volumes was also a consideration, to ensure comfortable levels for daytime customers and staff, with the capacity to turn up for evening events.

Four ZX1i in white provide the highest output for the main part of the shop. Seamless coverage into the adjacent areas is handled by four EVID-S5.2 in white, with low-end support from a pair of EVID-S10.1D subwoofers, also in white. A pair of EVID C4.2 ceiling speakers provide overhead sound. Outside, four EVID-S5.2 in black compliment the darker finish of the shop's exterior. All the Electro-Voice loudspeakers are powered by five Dynacord L1300FD power amplifiers.



Harudot Chonburi was created to provide a feast for all the senses, and by all accounts the audio lives up to the sublime quality of their coffee!

Equipment list:

- 4x ZX1i-90W 8" two-way loudspeaker (white)
- 4x EVID-S5.2W two-way 5.25" loudspeaker (white)
- 4x EVID-S5.2B two-way 5.25" loudspeaker (black)
- 2x EVID-S10.1D dual-10" subwoofer (white)
- 2x EVID C4.2 two-way 4" coaxial ceiling loudspeaker
- 5x Dynacord L1300FD 2x 650 W power amplifier

Harudot Chonburi

ElectroVoice

Dynacord



MG Series Supports G20 Summit India 2023



MG6S Series

- High stability and high reliability
- Increased LED'S thrust
- High contrast ratio and brightness, clearer display



Hunan Yestech Optoelectronic Co.,LTD.

✉ yestech@yes-led.com

🌐 www.yes-led.com

☎ +86 731 8453 9619





Snap One Appoints PT Inti Megah Swara as its Exclusive Distributor in Indonesia

INDONESIA: Strengthening its commitment to meet the growing market demand for its full line of products and solutions in the Indonesian marketplace, **Snap One** has announced a new exclusive distribution partnership with **PT Inti Megah Swara (IMS)**, one of Indonesia's largest distributors of audio/video/lighting solutions.

According to Adam Merlino, Snap One vice president and general manager for the Asia/Pacific region, the new distribution agreement benefits custom integrators and customers across Indonesia with greater product selection and availability.

"Our partnership with PT Inti Megah Swara will increase Snap One's brand awareness and local knowledge. I am excited to bring to market an ever-expanding product and solution portfolio including; Control4, our leading hardware and software platform for the connected home, Araknis Networks, Binary MoIP (media over IP), Wattbox smart power and Luma surveillance (NDAA certified) all powered by OvrC, the industry's #1 remote monitoring and management platform. Additionally, we will be bringing to market our entertainment solutions from Triad and Episode along with our infrastructure products from Strong and Wirepath," said Merlino.

"With IMS, Snap One will provide industry professionals (Partners) the products and platforms required to deliver exceptional connected experiences throughout Indonesia," Merlino emphasized. "We are committed to helping custom integrators, homeowners and companies across the country achieve their smart home dreams and business technology goals with leading Snap One solutions."

The new exclusive distribution agreement supplants a prior distribution model that relied on select Snap One direct Partners.

"As the largest AVL distributor in Indonesia, PT Inti Megah Swara makes a natural distribution partner for one of the world's leading custom integration manufacturers," said James Eric Pribadi, director of PT Inti Megah Swara. "This new agreement gives individuals and businesses increased access to cutting-edge smart technologies that enhance operations and daily activities while increasing sales and installation opportunities for the nation's professional custom integrators."

Established in 2000, PT Inti Megah Swara (IMS) is an audio/video/lighting distribution company based in Indonesia. Currently, IMS is the official distributor in Indonesia for many international-class audio brands.

At first, IMS focused on the retail market in Indonesia, and now has about 40 stores named Desound and JBL stores located in the country. In addition to its head office in Jakarta, IMS also has branch offices in

Bandung, Surabaya, Makassar, Manado, Malang, and Bali.

In 2019, IMS expanded the business to professional audio and in 2022, IMS further expanded to professional lighting. With this exclusive distributor appointment from Snap One in 2023, IMS is confident in its ability to provide comprehensive solutions to customers, with smart solutions for homes and businesses being the focus of IMS business alongside professional audio, professional lighting, and retail.

Moreover, IMS's subsidiary company, PT Sonido Musica Indonesia, is the official distributor of renowned music instrument brands. Thus, IMS is ready to serve all professional audio and lighting needs in cafes, restaurants, houses of worship, events, concerts, and other public places and smart solutions for homes and businesses.



Novatech Takes Brompton Technology LED Video Processing Solutions 'On Tour' at the ENTECH Roadshow

AUSTRALIA: Based in Adelaide, South Australia, Novatech Creative Event Technology stands as one of Australia's foremost and most respected audio-visual production companies and has been providing

technical production services for major corporate, arts, music, and sporting events for over two decades. With a strong commitment to nurturing its team's skills and striving to constantly be at the cutting-edge of creative event technology, Novatech is set to unveil its latest turn-key offerings in vision, audio, and lighting for live events at this year's ENTECH Roadshow from October 10th to 24th. This showcase will feature demonstrations of state-of-the-art LED processing solutions from Brompton Technology.

As the exclusive touring trade show for AV and entertainment technology professionals, Entech covers every major population centre in Australia, including Sydney, Melbourne, Brisbane, Adelaide, and Perth. It brings a fresh perspective to the industry, in

each local market it visits, opening up access to more business opportunities than any other event.

Leko Novakovic, managing director at Novatech, states, "As a full-service production rental company supplying turn-key event technology solutions for three major sectors, concert and touring, corporate, and special events, our high-end vision offerings encompass everything from projection mapping to large-scale LED screen solutions for live events. We have relied on Brompton Technology LED video processing products for many years in the latter."

The company's touring LED inventory features an impressive line of Brompton Technology LED video processing solutions, which it uses in conjunction with its extensive array of ROE Visual products. This includes the latest 4K Tessera SX40 LED processors supported by Tessera XD 10G data distribution units, offering a sophisticated single-box solution specifically designed to address the challenges posed by large LED display systems. Other Brompton solutions in Novatech's repertoire include the Tessera S8, Tessera S4, and Tessera T1 LED processors. ROE Visual products include Roe Carbon CB3, as well as Roe Carbon CB5 AirFrame and the recently purchased Roe Vanish V8T, with the latter two solutions both exclusive to Australia.

When discussing their choice of Brompton Technology as the LED video processing manufacturer of choice for the numerous events they support, with recent examples being Sydney WorldPride 2023, Santos Tour Down Under, Rufus Du Sol Australian national tour 2022/23, LIV Golf Adelaide, Now or Never, and Fatboy Slim, Novakovic confirms that the selection of Brompton is due to their reputation as "the best in the business". This choice, in turn, enhances Novatech's ability to meet touring requirements and provide top-quality LED screens.

"We appreciate the flexibility, ease of use, and on-site reliability that Brompton solutions offer," says Novakovic. "Our crew enjoys using them, and the Tessera features are remarkably intuitive and user-friendly. Brompton's commitment to evolution and continuous improvement also makes them a valuable asset. The company consistently invests in adding new features that give our technical team the tools they need to deliver the best results for our artists and clients in a timely manner."

"Novatech has been built on innovation for the past 22 years, using the world's best gear to give the best experiences possible for our clients, artists, and audiences alike. When upgrading our LED inventory around five years ago, it was only natural to use the best around, and there was no question as to what processors we'd be using, it had to be Brompton. And we've never looked back!"

"Collaborating with the Novatech team has unveiled a multitude of opportunities for Brompton in Australia," concludes Elijah Ebo, Brompton's Director of APAC Operations. "With their adept technical and production staff of over 65 professionals, and their bespoke touring solutions, Novatech can provide any production component or even manage entire productions if required. Their team creates moments that eventually turn into cherished memories, and we are privileged to have earned their trust for use in numerous impressive events across the country."

The ENTECH Roadshow began in Sydney on the 10th of October and then proceeded to Melbourne on October 12, Brisbane on October 16, Adelaide on October 19, and Perth on October 24

Brompton Technology



Danish Tech Powerhouses Airtame and Jabra Partner to Optimize Hybrid Collaboration with World Class Conferencing Solutions

INTERNATIONAL: Airtame, creator of the hardware-enabled SaaS platform that allows seamless screen sharing, digital signage and video conferencing collaboration in businesses and schools, today announced a partnership with Danish-based Jabra, a leader in professional audio and hybrid work solutions, to provide a comprehensive, cross-platform meeting solution that eliminates common challenges in hybrid meeting spaces.

“Partnering with other industry leading companies is critical to us so that we can provide end-users with the flexible solutions and support required to thrive while collaborating across hybrid workspaces,” said Jonas Gyalokay, Airtame co-founder. “Joining with Jabra allows Airtame to stay true to our mission of delivering

a seamless hybrid meeting experience to anyone, anywhere, at any time.

The Airtame hybrid conferencing platform stands out as the most versatile option available on the market. It is specifically designed to integrate with peripheral manufacturers, providing the most technologically advanced wireless hybrid meeting experience possible, with additional compatibility with Microsoft Teams, Zoom, and soon, Google Meet and Webex. By integrating with Jabra’s industry-favourite collaboration solutions, it allows for optimal integration without compromising the quality or performance of either solution. The speaker phones in the Jabra Speak line-up, the PanaCast 180 degree FoV meeting room camera and PanaCast 20 personal webcam, and the award-winning PanaCast 50 all-in-one video bar are all available for pairing with the Airtame Hub. With this compatibility, Airtame’s hybrid conferencing platform is more adaptable than ever, providing optimal hybrid meeting solutions for small, mid-sized, and large conferencing spaces.

Integrators and end-users can now leverage the powerful capabilities of Airtame’s hybrid conferencing platform, combined with compatible Jabra solutions, to enhance communication and collaboration in their organizations, schools, and hybrid workspaces. Together, these two Danish tech companies are making a significant impact by creating a simpler, smarter, and more engaging collaboration experience, ringing in the future of collaboration in the AV industry.

“Our partnerships within the collaboration technology ecosystem provide solution options for customers,” said Holger Reisinger, SVP, Jabra Enterprise Video Solutions. “The Airtame solution provides a choice for customers who want a flexible solution for their hybrid environments.”

Airtame

Jabra



Photo credit: CosmoVision.

Hong Kong Space Museum Over the Moon with PIXERA Mini

HONG KONG: An ultra-compact PIXERA mini media server is punching above its weight at a new interactive exhibition focusing on the world's largest infrared space telescope.

Launched in July, *Golden Eye on the Cosmos* is a new permanent exhibition at the Hong Kong Space Museum spotlighting the innovative technologies and scientific goals of the James Webb Space Telescope, the largest infrared space telescope ever built. The exhibition features a model of the Webb telescope, along with projected displays of images captured by its cameras and exhibits demonstrating the science behind infrared astronomy. As an exhibition that relies heavily on projected images and video, *Golden Eye on the Cosmos* required a media server solution that would ensure stable video playback and flexible projection mapping and geometric correction capabilities, explains Jason Yeung of Hong Kong-based system integrator CosmoVision. To meet this

objective, Yeung and team specified a single PIXERA mini Dual server, which handles all video content layering and output projection mapping, including the spectacular projection-mapped images of the cosmos which are the highlight of the exhibition.

The size of the PIXERA mini Dual – an ultra-compact (1RU) media server for digital signage and multi-display applications – was also ideal for the Space Museum, says Yeung. “The installation was relatively simple, but the exhibition space was comparatively small,” he comments, “so the PIXERA mini was the perfect size to be hidden away behind the show exhibit while not compromising in terms of performance and stability.”

Due to the limited space for the installation, the Christie projector used in the exhibition had to be paired with an extreme wide-angle fisheye lens, which created significant distortion. “Hence, all the image correction and warping was done within PIXERA to ensure that the content is not distorted or deformed in any way,” Yeung continues. The PIXERA software also fulfilled another client requirement, he adds: “They wanted to have show control without having to involve another third-party system, which made PIXERA Control the perfect complementary show control solution to interact with other elements in the exhibition.”

Recognising their role in helping to deliver an immersive experience in a challenging space, Yeung is full of praise for both the PIXERA media server and software. “As always, PIXERA provided the ideal hardware, software and support to allow us to realise this project,” he concludes.

CosmoVision **PIXERA**

Hong Kong Space Museum



Biamp Announces Direct-to-Market Distribution in Australia and New Zealand

ANZ: Biamp, a leading supplier of professional audio-visual solutions, today announced it will transition to a dealer-direct model in Australia and New Zealand (ANZ) in early 2024, to enhance its ability to support customers and drive growth.

Following the recent opening of the new Australian headquarters in Brisbane, Biamp is now transitioning to a dealer-direct model to strengthen company sales, support, and product distribution in the regions.

The change in channel strategy enables Biamp to pursue opportunities more aggressively in all vertical markets: corporate, food service and hospitality, retail, large venues, education, religion, sports and leisure, and outdoor applications.

“With ANZ being one of the biggest and most important markets in Asia-Pacific, we are confident that our decision to go direct will allow us to serve our partners more effectively. Bringing on board an experienced ANZ sales force coupled with an

expanded pre- and post- sales support team will allow us to engage dealers more fully throughout the ANZ markets. This, in combination with our consultant support and business development group, will ensure that we achieve our ambitious growth plans for the region. We are convinced this is the best way to promote complete solutions serving all target markets,” comments Niclas Brattberg, general manager, Middle East and Asia Pacific Markets.

Biamp is collaborating with its long-time partner Jands on a 90-day transition plan that will ensure all customers are fully supported throughout and after the change. Any changes to purchasing, support, and training processes will be communicated in advance. In the interim, standard purchasing and support processes remain in place and proceed as normal. To stay up to date with the latest news and developments, customers are encouraged to visit www.biamp.com/anz, a new landing page dedicated to this exciting transition.

“We want to thank Jands for their years of commitment to the Biamp brand,” added Niclas. “Working together, we doubled sales and built the brand to a place where it can support even more growth. This change is required to sell complete solutions to a larger set of customers in ANZ.”

Biamp Systems



Toyota Alive Space Reaches for the Stars with HARMAN Professional Solutions

THAILAND: To deliver unconventional and unforgettable showroom experiences for visitors to the new Toyota Alive Space facility, Mahajak Development Co., Ltd. and HARMAN Professional Solutions installed a comprehensive slate of state-of-the-art audio, visual and control technology.

Toyota Alive Space is a newly opened showroom and experience centre spanning 48,000 square meters at the heart of bustling Bangkok. The facility comprises three main areas—a main community space, a multi-purpose event hall and an office workspace—linked together by a bold and futuristic space aesthetic. The

communal space not only showcases Toyota's latest vehicles, but it also features facilities seldom found at a car showroom, including an E-sport area for virtual driving simulations, a co-working space with high-speed internet, a yoga studio for health lovers and an Alive Kids Club to appeal to young families. Given the number of ambitious features at play, Toyota Space Alive required the latest in AV technology to ensure reliable and efficient operation and communication throughout the facility. To meet this goal, Mahajak Development Co., Ltd., collaborated with HARMAN to deliver high-calibre solutions by JBL Professional and Crown Audio.



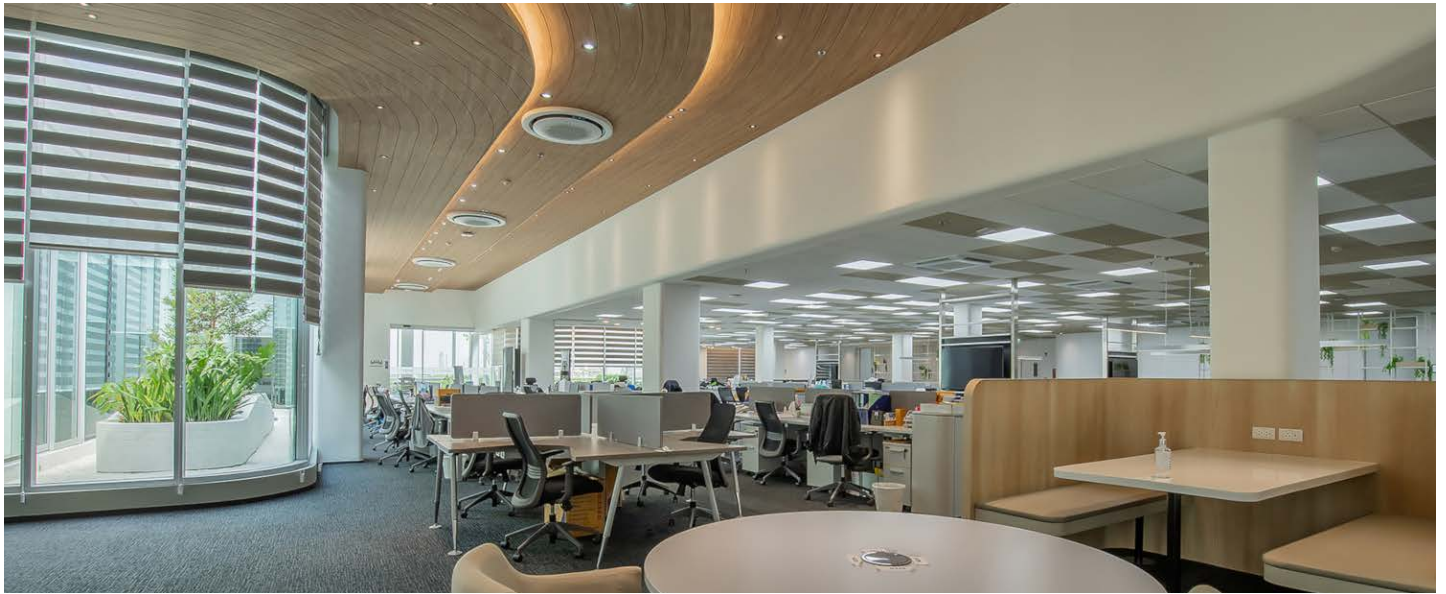

For most of the office areas, JBL 8124 full-range ceiling loudspeakers deliver clear, high-fidelity performance while blending seamlessly into the overall space. The installation team also installed 8124 speakers in the meeting and board rooms, with the addition of JBL Control 50S/T subwoofers to deliver impactful low end and an impressive 32 Hz–20 kHz frequency response in a compact and sleek design. A combination of Crown CT875, CT475 and XTi1002 amplifiers ensure consistent output, low-latency processing, and easy-to-use controls. The resulting system ensures that Toyota employees can enjoy crystal clear sound for virtual meetings and presentations—and collaborate without the need for troubleshooting.

Finally, the office relaxation zones utilize JBL Control 85M coaxial mushroom landscape speakers, which offer 360 degrees of coverage while blending into the surroundings, and the overall background music system is powered by a Crown CDi 2000 amplifier. Crown CT475 and XTi1002 amplifiers also provide power to the prototype showspace, giving guests a high-quality and immersive experience.

“Working with HARMAN has once again been a positive experience,” said Yodpol Kaewsuttha, professional solution - project sales manager, Mahajak Development Co., Ltd. “We’re also thrilled with the continued reliability and versatility of JBL and Crown solutions.”

“We are proud that HARMAN Professional Solutions has been instrumental in making their vision a reality and look forward to future collaborations with Mahajak Development Co., Ltd.,” said Amar Subash, VP & GM, HARMAN Professional Solutions of APAC.

HARMAN



Gary Goh, group CEO, Broadcast Professional and Genelec international sales director, Ole Jensen.

Genelec Joins Forces with Broadcast Professional to Strengthen APAC Distribution Network

APAC Genelec, a leading international brand in professional loudspeaker solutions – has further strengthened its distribution network in the APAC region through the appointment of Broadcast Professional Pte Ltd as its new distribution partner for Singapore and Malaysia, with responsibility for Genelec's entire range of Studio, AV and Home Audio products across the two territories.

Founded in 1983 and currently celebrating its 40th anniversary, Broadcast Professional started life in Singapore as a subsidiary of Studer AG, serving the growing needs of the broadcast and recording industries across the region. Since then, it has widened its services to include broadcast and streaming services, as well as the creation of Immersive

Experiences. With a unique combination of people, services and technology, Broadcast Professional is committed to ensuring better outcomes for its customers by speaking the language of the industry.

Genelec international sales director, Ole Jensen commented, "APAC has been a key strategic market for us for many years and having already established our own subsidiaries in China and Japan, the partnership with Broadcast Professional is a natural step in building our presence and delivering further growth across the region. With its strong focus on technical excellence and providing an unrivalled customer experience, Broadcast Professional's values correspond perfectly with our own – and we're extremely excited about the potential that we can unlock together," says

"As a company, we're constantly seeking opportunities to expand the range of products and services that we offer our clients. Therefore, when discussing a partnership with Genelec in Singapore and Malaysia, the decision was straightforward – and we look forward to collaborating with Genelec to develop this market," said Joseph Ho, director, Broadcast Professional.

Gary Goh, group CEO, Broadcast Professional, added, "We're pleased to announce this strategic partnership with Genelec, a company with a long heritage of excellence. This collaboration unlocks the potential of great synergy between our organisations and perfectly aligns with our vision of providing our valued clients with industry leading solutions."

Genelec

Broadcast Professional



Avientek Join Hands with LEA Professional in the Middle East for a New Partnership

MIDDLE EAST: **LEA Professional**, a manufacturer of innovative, high-quality, professional-grade amplifiers with cloud- and IoT-based technologies, announced its partnership with **Avientek**, a leading audio-visual (AV) distributor across the Middle East. This strategic partnership utilizes Avientek's wide-spread vendor and channel partner network in combination with LEA Professional's award-winning technology to support the increasing demand for cutting-edge audio solutions in the region.

Avientek maintains a prominent position as a value-added distributor in the audio-visual and unified communication sectors across the Middle East, Africa, and the Indian Subcontinent.

Avientek's trustworthy solutions earned the confidence of partners and clients to scale up to high-end projects with complicated design needs. Avientek has become a market leader for quality and innovative system solutions through its consistent technical expertise and attention to customer needs.

"A key part of our growth strategy focuses on our continuous dedication to delivering user-friendly, quality AV products sourced from globally renowned vendors such as LEA Professional," VM Manu, director of Avientek shared. "LEA amplifiers and solutions are a perfect complement to our portfolio. Its ongoing commitment to innovation, combined with its well-established and dependable technology, instills the assurance we require to address the needs of our valued customers."

LEA Professional's smart, professional-grade amplifiers deliver one of the most feature-rich and affordable amplifiers available in the industry – featuring onboard DSP, a web browser-based user interface, third-party API control, and more audio system enhancements. The Avientek team identified the unique attributes that differentiate LEA Professional solutions from powerful solutions as the demand for agile audio solutions continues to grow.

"Avientek's presence throughout the region and strong track record supporting technologically advanced brands made them an ideal distributor to bring LEA Professional's technology to a wide customer base," said Scott Robbins, Vice President of Global Sales at LEA Professional. "Pairing that with their high-quality customer service, we're confident they will represent the LEA Professional solutions with the same passion and care that we exemplify."

Find a detailed regional breakdown and contact information for all LEA Professional representatives and distribution partners online at [LEA's Partner Map](#)

Aetria – Datapath’s Scalable and Future-proof Solution that is Fitting for the Modern Control Room

Datapath aims to transform control rooms through Aetria, an integrated solution comprising robust hardware components and innovative software. This comprehensive offering guarantees scalability and future-proofing for control rooms of all sizes



Control solutions like Datapath’s Aetria gives operators access to any source anywhere with AVoIP with KVM functionality.

Traditional control rooms often lack the scalability and flexibility required to accommodate future technological advancements and changing operational needs. With emerging technologies like artificial intelligence and automation becoming more prevalent – along with continuing data growth - control rooms need to have the infrastructure and capabilities to integrate and adapt to future developments.

The growth of data continues at pace

In this data-driven world, control rooms face the challenge of managing and monitoring multiple sources and video feeds from various operations. This influx of information has become too overwhelming for traditional systems to handle effectively.

Moreover, control room operations are being consolidated both functionally and geographically.

Smaller control rooms are being merged into a centralized control room to enhance communication and collaboration.

For instance, airports are combining emergency services, baggage handling, immigration, flight control, and other operations into a central Airport Operations Centre. Similar consolidation efforts are taking place in the power utilities sector, including electrical generation & distribution, oil and gas production facilities, and rail traffic management.

Consequently, challenges arise regarding the migration, organization, and control of data sources for each function. Ensuring critical information is accessible to operators within and outside the control room remains a significant hurdle.

Control room integration and consolidation

Many control rooms are designed with specific applications in mind, often centered around a single systems vendor for a particular function. These core applications serve as the main function within the overall control room. However, alongside these core applications, there is also a need to monitor and control other complementary data sources, such as CCTV cameras, web pages, TV feeds, and external third-party systems. The integration of these additional sources into the control room poses various technical, commercial, and legal challenges that must be overcome.

Consequently, control rooms often struggle with outdated technologies and design principles, which result in a lack of necessary tools and information displays for operators. This limited situational awareness, coupled with inefficient workflows, leads to frustrated operators and negatively impacts response times and decision-making abilities.

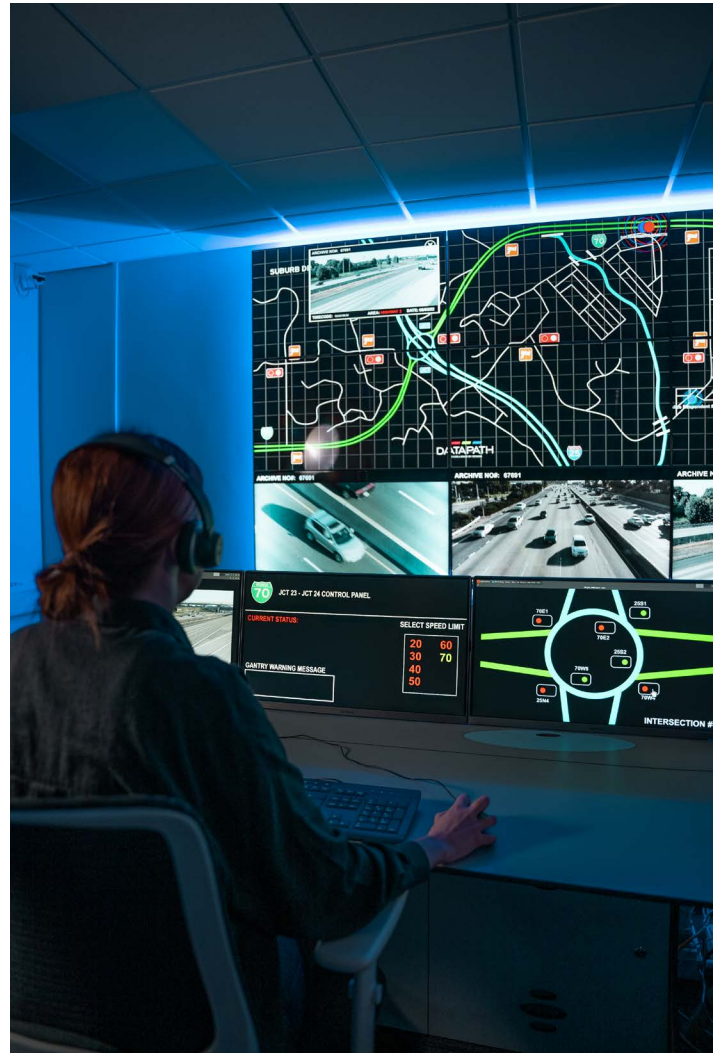

Sources can be efficiently distributed throughout the control room environment, granting operators timely access to relevant information.

Advancements of data visualization and control

The adoption of AVoIP technology is rapidly advancing, playing a crucial role in ensuring seamless communication and efficient operations. This technology allows for the transmission of high-quality audio and video signals over a network infrastructure, enabling real-time monitoring, collaboration, and decision-making.

The way operators access this data is also evolving. Many control rooms are now opting for larger workstations that provide individual operators with

access to a greater number of data sources. This allows for improved situational awareness at an individual operator level.

At the same time, there is growing need for smaller video walls and/or individual large displays setups designed for sharing information among smaller groups of operators, promoting more efficient collaboration.

24/7 operation

A crucial necessity for numerous critical services and applications, which must consistently be accessible to users, is 'high availability' - the capacity for a system or network to remain operational and reachable for an extended duration, typically without any discernible downtime or interruptions. Attaining high availability entails incorporating redundancy and fault tolerance mechanisms across the infrastructure. This frequently encompasses redundant hardware components like servers, network devices, and storage systems, as well as resilient software configurations capable of withstanding potential failures.

Security

Probably, the utmost crucial aspect of a Control Room operation is security. This significance is magnified even more when dealing with copious amounts of potentially sensitive data transmitted over a network. Connections between connected devices should be fortified with enterprise-grade AES encryption, where user and API connections utilize TLS encryption, guaranteeing that all information remains secure in the possession of authorized operators.

Future-proofing control rooms with Aetria

Datapath's Aetria solution is now deployed globally in control rooms, utilized in prestigious locations such as Presidential palaces, defense hubs, and businesses of all sizes across every continent. Aetria offers a consolidated and centralized AV solution that simplifies the viewing and interaction with various data sources and IT systems from multiple vendors. It provides a unified platform that is easy to manage, maintain, and adaptable to emerging technologies.

Aetria proves invaluable as data volume grows, assisting operators in comprehending the information. By leveraging Aetria, sources can be efficiently distributed throughout the control room environment, granting operators timely access to relevant information.

Moreover, all Aetria installations are equipped with redundant systems, guaranteeing uninterrupted operations by automatically transferring video wall, workstation, and data source configurations to backup systems.

Talk to the Datapath team

For more information on Datapath solutions, please visit www.datapath.co.uk or call +44 (0)1332 294441.

Extron Introduces Powerful 4K Collaboration and Presentation Switcher with USB-C



Extron is pleased to introduce the UCS 303, a powerful collaboration and presentation switcher designed to meet the unique needs of UC meeting spaces. Three inputs support connection of USB, HDMI, and DisplayPort sources, while five USB device ports connect to peripherals such as USB cameras and microphones. The USB-C input provides video/audio, USB, and 60W of power to charge a user's laptop computer. With the UCS 303, meeting spaces can integrate a room's USB cameras and microphones with users' portable laptops into Teams or Zoom meetings.

According to Casey Hall, chief marketing officer for Extron, considering the ever-increasing need for on-the-go collaborative spaces that help people meet, share information, and connect, Extron are always looking for innovative ways to help their customers streamline the installation and maintenance of UC

meeting rooms. The UCS 303 4K Collaboration and Presentation Switcher makes it easy to integrate AV sources and USB cameras into UC Teams and Zoom meetings, while providing features that offer greater flexibility, convenience, and a more intuitive user experience.

The UCS 303 offers intuitive collaboration with auto switching, which can prioritize inputs, providing natural switching and minimal user interaction with AV hardware. Small huddle spaces will benefit from UCS 303 support of TeamWork Show Me cables and retractors, which places control at users' fingertips. The UCS 303 makes it easy to integrate AV sources and USB cameras for Teams and Zoom meetings, into huddle, meeting, and collaboration spaces.

Extron/UCS303

RGB Spectrum Introduces Next-Gen Zio Recording & Media Server, Providing Enhanced Video Capture and Playback Functionality



RGB Spectrum, an industry leader in mission-critical video for real-time decision support, today announced its latest innovation, the **Zio Recording & Media Server**. Designed to cater to the evolving needs of mission-critical applications, the new recorder handles all types of visual data, including natural and computer-generated video.

The Zio Recording & Media Server is available in various models designed to support multiple streams for recording and playback simultaneously, with storage options sized to meet specific customer requirements.

The system incorporates a First In, First Out (FIFO) architecture. As storage space approaches its limit, the server automatically deletes the oldest recordings, making room for new content without manual intervention. This ensures continuous recording capabilities 24/7. Users can designate content to be preserved without auto-deletion to prevent critical segments from being lost.

The new Zio server includes the following features:

* **Single Video Clip Playback**

To view a video clip, a user simply chooses it via an intuitive drag-and-drop interface.

* **Synchronized Group Playback**

Users can play multiple recorded sources with the synchronized group playback feature. Synchronized playback of related events improves decision-making and collaboration.

* **Advanced Playback Controls**

These controls empower users to find and extract important information from an incident expeditiously. Alongside standard options like Stop and Pause, users can choose playback speeds from 0.1x up to 10x. The Jump to Time feature allows users to initiate playback from a specific time and date.

* **Export for External Playback**

The Zio Recording & Media Server facilitates the seamless export of video clips via the Internet or telephone networks. Video clips can be viewed and analysed wherever and whenever needed. As part of the **Zio AV-over-IP platform**, the server can support playback on video walls, multiview monitors, tablets, and smartphones.

RGB Spectrum

ViewSonic's Foldable 135" LED Displays Offer Enhanced Flexibility and Agility to Hospitality and Event Industries



The company's foldable 135" All-in-One LED Display <https://www.viewsonic.com/global/products/direct-view-led/LDS135-152> provides a seamless large screen and fast and seamless setup. It offers higher mobility without the logistical issues associated with big screens, making it an ideal solution to provide better convenience, flexibility, and outstanding visuals for various events.

Through years of collaboration with clients in the hospitality and event sectors, ViewSonic has gained invaluable insights into the challenges faced by operators in these fields—especially when it comes to finding the right large-format displays. Critical challenges for these industries include limited labour, time, and resources:

A significant amount of time and a specialized workforce is usually required for professional audio-visual installations.



Large displays are often wall-mounted and limited to one location. Even if some are installed on a floor stand, they are still difficult to move, requiring a compromise between size and movability.

Transporting large displays can be expensive and logistically complex, involving significant cost and effort.

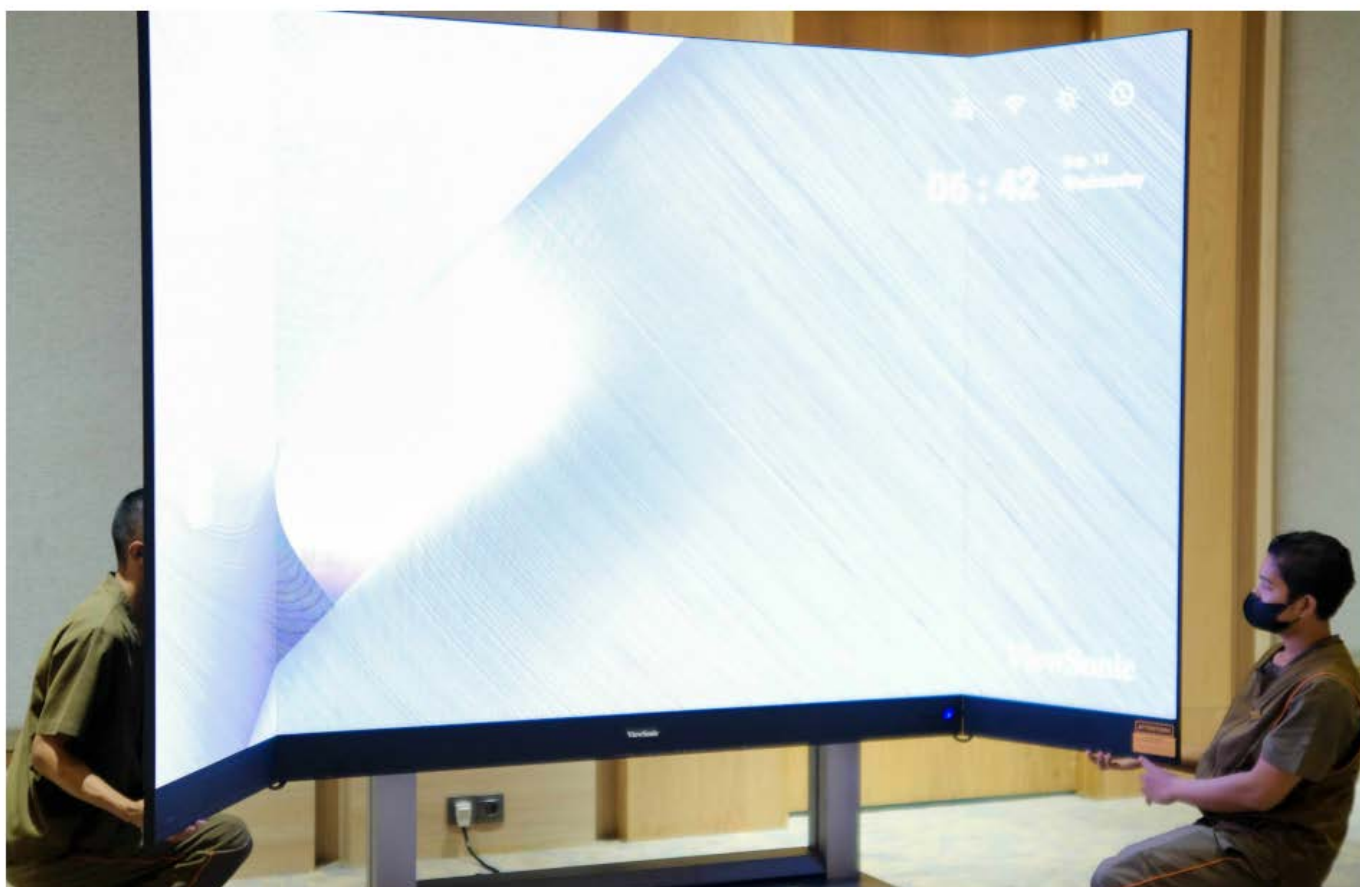

Additionally, external audio equipment is usually required for applications demanding reasonably good quality sound.

Due to the complex configurations of various AV systems, trained professionals are required to operate and maintain large displays. Furthermore, a dedicated space to assemble and manage the equipment is also needed.

Foldability for Flexibility

Customers constantly seek greater agility for event spaces in the dynamic hospitality and event industries. As a result, fully-fixed installations of large and bulky displays are seeing decreased demand. ViewSonic's foldable All-in-One LED Display was developed with precisely these challenges in mind. Its pre-assembled and mobile design significantly simplifies the setup process and offers a range of benefits, including:

Versatile applications: Thanks to its mobile design, the large display can be relocated freely to various locations, allowing a single screen to serve multiple spaces—rather than installing multiple fixed units across different rooms and saving the hassle of revamping the space. For instance, hotels and restaurants can use it to serve various occasions, from screenings of sporting events and movies at the rooftop bar to displaying promotions for upcoming activities in the lobby. It can also be used as a digital backdrop at banquets, ceremonies, or trade shows.

Ease of transportation: With a foldable screen, the massive 135" LED display can easily fit into traditional freight elevators and larger passenger elevators when moving. This reduced form factor makes transport a breeze—between rooms on different building floors.



This high level of flexibility and mobility also assists rental businesses in meeting clients' needs for one-time or occasional use. The massive foldable screen came contained in a mobile flight case with wheels to facilitate safe and easy transportation between venues in different cities.

Compared to other displays of a similar size, ViewSonic's foldable LED display with reduced packaging size is a cost-efficient solution for event organizers and exhibition companies to reduce both logistics costs and labour. For instance, it eliminates the need to rent a humongous vehicle and forklift to deliver and unload it.

Intuitive setup and operation: The foldable All-in-One LED display is pre-assembled with LED modules, cabinets, a system control box, and an adjustable motorized floor stand, all fitting into a mobile flight case. Once unboxed, the display can be set up easily by two people for instant use in just 10 minutes—even by staff with little-to-no knowledge of audio-visual technology. With a built-in operating system and wireless connectivity, users can directly stream content onto the display from mobile devices.

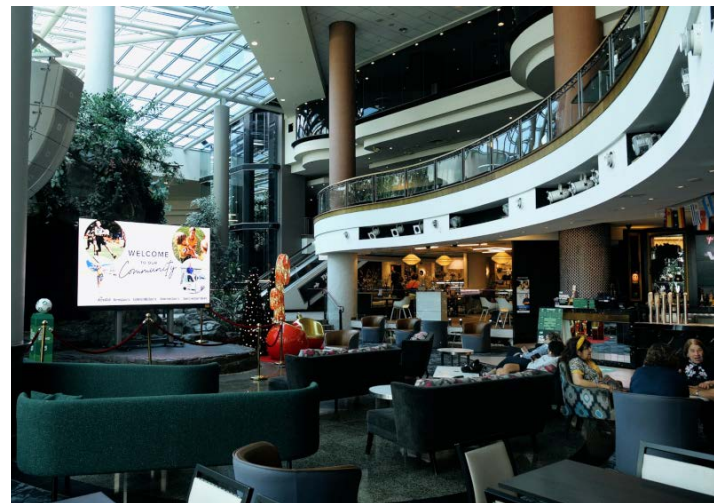

Elevated audience experience: With its premium aesthetics and incredible audio-visual performance, the 135" LED display's bezel-free and grid-free design offers a seamless and unique viewing experience. The display's vibrant colours are boosted by ultra-high brightness levels, which allows audiences to see images clearly in various lighting environments. Built-in Harman Kardon speakers round out the audio-visual package, providing a detailed, rich sound right out of the box and negating the need for additional audio equipment.

ViewSonic

RF Venue Architectural Antenna Duo Deliver Invisible Performance for Wireless Mics and IEMs

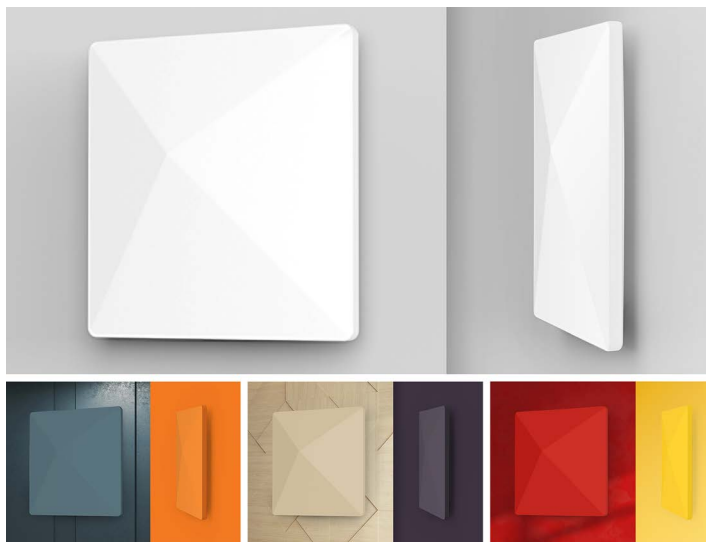

RF Venue's low-profile Architectural Antenna series housings can be installed on a wall or ceiling and painted to match any interior for aesthetic neutrality and invisible performance.

Wouldn't it be nice if RF antennas could be as invisible as the signals they capture? With its Architectural series antennas, RF Venue, a global leader in essential RF accessories for wireless audio, has achieved that goal, while still delivering renowned antenna performance for both wireless microphone and wireless IEM systems.

According to RF Venue chief innovation officer Chris Regan, RF Venue's engineers have performed magic with the Architectural series antennas, in that they have made them "disappear" into the interior structures they are mounted on. The patented cross-polarized technologies of RF Venue's dual-diversity Diversity Fin Antenna for wireless mics and the proven design of the circularly polarized CP Beam Antenna for wireless IEMs are folded into identical slim, compact Architectural series enclosures that can be ceiling- or wall-mounted and painted to match any interior. The



The ceiling-mounted RF Venue Diversity Architectural Antenna unobtrusively provides the O'Connell's Pavilion in Queenstown, New Zealand with reliable wireless microphone coverage throughout its target zone.

small footprint and thin profile of the Architectural series antennas facilitates placement for optimum RF line-of-sight, while colour matching the housings to their surroundings let them hide in plain sight. The combination of the CP Architectural Antenna and the Diversity Architectural Antenna delivers rock-solid installed wireless audio system performance where mics and IEMs are used together, and visually disappear where appearance is important.

The benefits of RF Venue antenna technologies are easy to explain to potential customers, and the performance brings them back as repeat customers, according to RF Venue senior applications engineer Don Boomer. In the past, when RF Venue's installers discussed antenna options for fixed install with the customers, the best technical solution was not always aesthetically acceptable. But now when RF Venue's installers point to the Architectural Antenna housings



The square RF Venue Architectural series antenna mounted on the high ceiling of this house of worship installation has low visual impact that would approach invisibility if painted to match the ceiling.

and emphasise what the Diversity Fin and CP Beam antennas can do, and suggest that they look like that, it is gratifying to see how delighted RF Venue's customers are to have these new tools available.

Jessey Foster, a loyal customer of RF Venue for essential wireless audio solutions, and owner and lead AVL designer for business tech provider (and now RF Venue dealer) Uniti Designs, says that he anticipates the Architectural Series antennas will be the dominant antenna choice in his permanent installation projects in the future for two reasons. Number one is that the architectural antennas are super flat such that when they are mounted on a wall or in a ceiling, they just disappear. In an install's black ceiling, Foster just painted the antenna black, and it can't be seen, at all. So, as far as the client is concerned, there is no antenna on stage, and that makes a significant difference.



A white-on-white wall mounting of an RF Venue Architectural series antenna.

Reason two for Foster is the one-two punch delivered when the Diversity Architectural and CP Architectural Antennas are used together: For example, an IEM antenna and a wireless mic antenna can be as close as six feet apart and you'll be amazed at the kind of coverage and clarity you get. Foster's clients, some of whom have been doing this for years and know what IEMs are supposed to sound like, immediately notice the difference in clarity. Almost every single time that Foster installs RF Venue in a build for them, the first thing they say is that they've never heard it this clear in their ears, before, and the microphones just work solidly, all the time.

The CP Architectural Antenna is available standalone and in 4 and 9 Channel Wireless In-Ear Monitor Upgrade Packs, which bundle the antenna with COMBINE4 or COMBINE8 antenna combiners and all needed cabling for a clean, easy setup. The Diversity Architectural Antenna is also available individually and in turnkey RF Venue 4 and 9 Channel Wireless Microphone Upgrade Packs that include antenna, an RF Venue DISTRO4 or DISTRO9 antenna distribution amplifier, and all cabling needed. The RF Venue Architectural Antennas and upgrade bundles work with wireless audio systems of any brand or model, and ship from stock.

RF Venue

JBL Professional Introduces FIR Tunings for Select Control Contractor Series Loudspeakers

Harman Professional Solutions, a global leader in audio, video, lighting, and control technologies, today announced its JBL Professional FIR tunings for select Control Contractor Series loudspeakers, providing further enhanced performance.

The FIR filters optimize both frequency response and phase response to a finer degree of precision than has typically been possible with standard IIR “parameter-based” filters. Additionally, these FIR filters were designed to meet JBL Pro’s new V6 FIR tuning standard.

V6 Tuning Features:

- Equalization to a neutral frequency response
- Improved linearized phase response above 300 Hz
- Allows users to start with a known flat voicing for further EQ’ing to the needs of the install
- Improved signal coherence
- Matched gain to allow for smooth system tuning and subwoofer integration

The V6 FIR tunings are for **COL600 & COL800**, **SLP12/T & SLP14/T**, **GSF6 & GSF8**, and **Control 68HP** products. The posted tunings are for use with **Crown DCI-N** and **DCI-DA** power amplifiers. Additional tuning files are expected to be released for **Crown CDI DriveCore** amplifiers promptly thereafter.

Offering superior sound and broad and targeted coverage choices for a range of indoor and outdoor

commercial applications, these full-range speaker and subwoofer models give installers versatile options for building new systems or augmenting existing systems.

All models feature premium multitap transformers for use in distributed systems and are switchable for direct operation. These sleek, elegant speakers—several of which are winners of prestigious international design awards for industrial design excellence—complement a broad range of décor and finishes. The Control Contractor V6 FIR Tunings were developed to enhance the Control Contractor line-up as a way of producing unmatched performance from this versatile loudspeaker line.



Additional Details

For complete product details and specifications, please visit:

- **COL600** Slim Column Loudspeaker
- **COL800** Slim Column Loudspeaker
- **SLP12/T** Sleek Low Profile Loudspeaker
- **SLP14/T** Sleek Low Profile Loudspeaker
- **GSF6** Full Range Loudspeaker
- **GSF8** Full Range Loudspeaker
- **Control 68HP** Pendant Loudspeaker

Downloads and Instructions for all Models:

- [Download Tunings](#)
- [Instructions](#)

[Harman Professional Solutions](#)

Nureva Enables Easy Multi-camera Switching in Larger Spaces with New Camera Zones Feature



Nureva Inc., an innovator in advanced audio conferencing solutions, announces a new camera zones feature for its **HDL410 audio conferencing system** that integrates its sound location data with the **INOGENI CAM230** multi-camera selector. Setup is quick, with only a few minutes needed to define up to three zones that are each mapped to a camera and its view of the room. During a meeting or class, sound location data is used to automatically activate the camera that is mapped to the zone where someone is speaking, making it easier for remote participants to follow the conversation. The feature is compatible with Microsoft Teams, Zoom and other UC&C clients that don't natively support multiple camera streams in a room. The CAM230 also works with any brand of USB or HDMI camera, including the **Nureva CV30**.

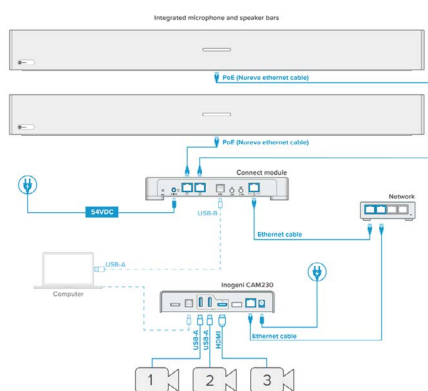

Camera Zones Connection Diagram

Camera zones are defined using a simple click-and-drag interface in Nureva Console, the cloud-based management platform included with every Nureva system. The HDL410 system's unified coverage map automatically generates a two-dimensional view of the room and the microphone coverage area, making it easy to create and map the zones. This IT-friendly approach eliminates the need for additional software and specialized technical expertise that are often required with traditional multi-camera switching solutions. The camera zones feature also complements any capabilities already built into the cameras, including PTZ functionality and face or body tracking.

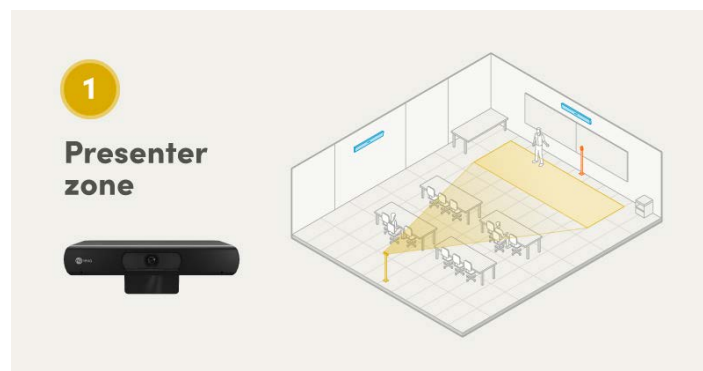

Automatic switching of two or three cameras in a larger space naturally creates a more engaging remote collaboration experience by giving remote participants a clear view of the active talker. For example, the camera view automatically switches between a presenter or instructor at the front of the room and others in the space, depending on who is speaking. This is essential to meaningful engagement with people joining remotely and avoids the burden of manually switching camera views. It also extends the capabilities of Microsoft Teams, Zoom and other UC&C platforms without the need for integration or

customization. This new simple, scalable solution is made possible by Nureva's patented **Microphone Mist technology**, which fills a room with thousands of virtual microphones that are used to accurately locate sound sources and provide full-room microphone pickup. Advanced algorithms pre-emptively ignore unwanted sounds, automatically adjust gain based on the position of the talker and continuously auto-calibrate the system in response to the changing acoustic properties of the space. Combined, these capabilities deliver clear, consistent audio to remote participants to accompany the video stream.

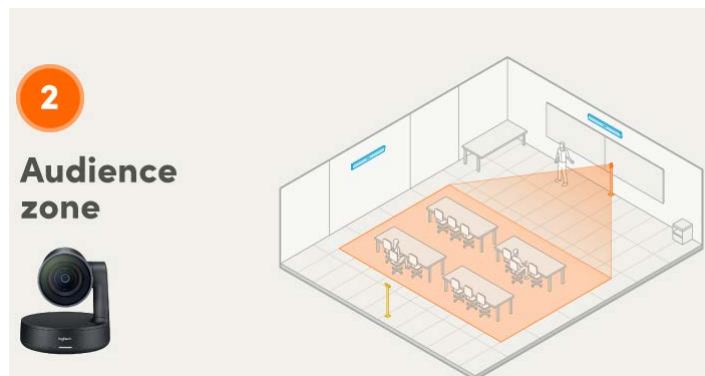

According to Nancy Knowlton, Nureva's CEO, the company is excited to offer IT teams a new and easy way to implement automatic camera switching in their larger working and learning spaces. The advanced capabilities of Microphone Mist technology continue to open up new opportunities to easily enable inclusive and engaging remote collaboration at scale.

Availability

Nureva's camera zones feature for the HDL410 system will be available in December 2023, with the purchase of an INOGENI CAM230 multi-camera selector.

Additional information on the unified coverage map



Nureva's patent-pending unified coverage map <https://www.nureva.com/product-news/feature-highlight-video-hdl410-unified-coverage-map> represents a ground-breaking approach to microphone pickup in larger spaces. It enables the physical mics from two microphone and speaker bars to be processed together instead of separately, creating a single giant microphone array covering the entire room. The HDL410 automatically determines the relative location of the two microphone and speaker bars and generates a coverage map when installed. Each virtual microphone is targeted with greater resolution and precision, resulting in pro AV performance without the complexity of setting up multiple lobes. This enables

- Precise sound localisation
- Increased processing gain
- No mixing or switching of artifacts
- More accurate and consistent gain control
- Accurate sound location data
- Flexibility in the placement of each microphone and speaker bar

Nureva

Latest ZeeVee ZyPer Management Platform Update Focuses on Enhanced Security Features

ZeeVee has released a major upgrade to its popular AV over IP ZyPer Management Platform (ZMP) making it the industry's most secure management interface for a network-based AV system.



Illustration of the three-part security parameters provided by ZeeVee's ZyPer Management Platform 3.0

The updates in the ZMP 3.0, taken as a whole, make it significantly easier for integrators and end-users to set-up and establish AVoIP system safeguards for networks, accounts, and GUI applications. All users will benefit from the upgrade, particularly those operating mission critical systems in the government, enterprise, higher education, and healthcare sectors. Configuration of these features is optional should this level of security not be required.

ZeeVee's main goal with the latest ZyPer Management Platform update was to make the set-up and management of IP security as pain-free and intuitive as possible. The combination of updated features reflects

the company's constant focus on security focused engineering and puts ZeeVee in a leadership role in the pro AV market.

Security Enhancements

Among the many new security features of the ZMP 3.0 platform are:

*** Network:** The platform features a comprehensive set of commands to manage X.509 certificates. This includes full certificate authority for the creation of root certificates (particularly useful for small networks), the signing of server certificates and the loading of root certificates into browsers for secure operation. The addition of TLS to GUI web access encrypts data and prevents man-in-the-middle attacks. It also features SSH command line access and SFTP file transfer capabilities.

*** Account:** Full account password security, failure lockout (both short term or until administrator readmits) and a session idle timer protect accounts from getting breached. Simple role functionality assigns each account with specific subsystem access levels and login banners for both web and shell access can also be put in place. In addition, it handles the 2fa handshake and generates a QR image for the token generation app.

*** GUI Application:** An intuitive, feature-rich GUI interface enables the easy execution of security tasks. ZeeVee software is assessed against the OWASP Top 10 most common vulnerabilities in web apps. It also deploys transport layer security (TLS) for network configuration and a PHP session ID cookie with 15-minute renewal. There is no access to any

security tokens via the application's JavaScript. Active session management shows all active accounts (web, SSH) including start and last active time, as well as all previous commands issued by all accounts. Forced logout can be activated in any session.

Additional ZMP 3.0 features include:

- * Latest Ubuntu version 22.04 on Proserver
- * Secure device and server updates
- * Support for ZeeVee ZyPerUHD60 Dante versions

[ZeeVee](#)

Extron XTP Systems 8K Boards Now Include Dante Support



Extron XTP II CrossPoint Series modular matrix switchers feature a 50 Gbps backplane to deliver a future-proof AV infrastructure that supports convenient growth and upgrade without needing to replace equipment. The newest board to join the XTP Systems family is the XTP II CP 4o HD AT 8K, an XTP output board with four HDMI and four Dante® digital audio outputs. It is HDCP 2.3 compliant and supports HDMI 2.1 performance at video resolutions up to 8K/30 HDR video with 4:4:4 colour sampling at data rates up to 40.1 Gbps. Dante output adds the capability to take any four stereo audio signals that are routed through the XTP® system and transport them as Dante audio over a network using standard Internet protocols. This XTP output board supports convenient integration as part of a complete networked audio system solution.

According to Casey Hall, vice president of worldwide sales and marketing for Extron, as transmission over

networks increase in popularity, Extron's customers are looking to support uncompressed 8K HDMI video plus Dante audio in one switching system. What is more, XTP now supports 8K HDMI and Dante audio with our new XTP II CP 8K output board, facilitating convenient system expansion with our complete line of Dante-enabled audio processing products.

XTP Systems provide a completely integrated switching and distribution solution for multiple video formats. They support local connectivity as well as extended transmission capability for sending video, audio, RS-232/IR, and Ethernet up to 330 feet (100 meters) over shielded CATx cable, and up to 10 km (6.21 miles) over fibre optic cable. Each system is HDCP compliant, and delivers ultra-fast, highly reliable digital switching with Extron's SpeedSwitch Technology. With hot swappable modular components, a wide selection of XTP transmitters and receivers, and advanced 24/7 system monitoring, XTP Systems are designed to provide continuous, trouble-free operation in the most critical installations.

For more information on the XTP II CP 4o HD AT 8K, [click here](#).

[Extron](#)

Christie Launches New Inspire Series and HS Series 1DLP Laser Projectors



Christie 4K860-iS (left) and the 4K13-HS (right) 1DLP laser projectors

Christie is pleased to announce the launch of two new 1DLP laser projectors, the 4K860-iS and the 4K13-HS. They are compact and flexible projection solutions for venues including classrooms, boardrooms, and places of worship.

The Inspire Series 4K860-iS is easy to move and install, weighing only 33 lbs (15 kg), and lights up screens with 8,500 lumens in 4K UHD resolution. Built-in Christie Twist, and optional Mystique software, provide warping and blending capabilities and camera-based alignment, respectively, to ensure content looks picture-perfect.

Easily illuminate large surfaces and screens with Christie's newest addition to the HS Series of 1DLP projectors. The 4K13-HS delivers 14,800 lumens for projects that require a high-brightness projection solution, but without compromising form factor. Images are sharp and clear with 4K UHD resolution, and colours are more natural, and blacks deeper, courtesy of built-in Christie BoldColor+.

According to Andy Wang, Christie's product manager, their newest additions to their line-up of 1DLP laser

projectors, offer customers even more choice when it comes to selecting the right solution for their project. Additionally, with 1DLP options ranging from 5,000 to 23,650 lumens, and features including passive polarized 3D and built-in warping and blending, Christie's projectors are designed to deliver the best possible on-screen image.

The 4K860-iS and 4K13-HS are compatible with the new Christie Intelligent Camera (CIC), a powerful accessory that makes it faster and easier to achieve the desired image quality. Operators can use it to calibrate projector color, trigger autofocus, and, when combined with Christie's complimentary **Mystique Lite** software, automate warping and blending of up to three projectors in a horizontal array.

The new models come with an industry-leading 5-year/20,000-hour warranty and are available for order now.

Christie

Extron and Zoom Deliver New Ways to Add Superior Collaboration and Control to Any Space

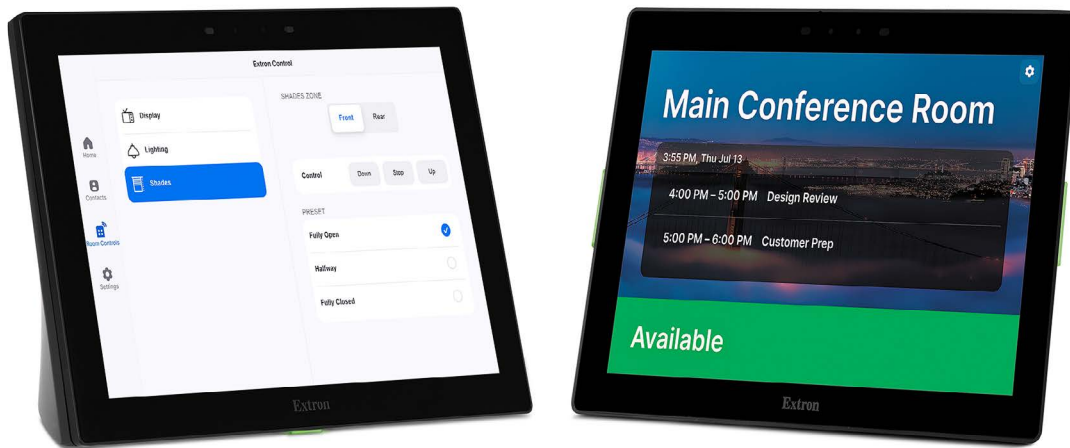

Extron is pleased to announce the ZRTP Pro Series of Zoom-certified touchpanels and the Extron Control for Zoom Rooms App. The ZRTP Pro Series are Zoom Rooms touchpanels that can operate as either a Zoom Rooms controller or a Zoom Scheduling panel. As a Zoom Rooms controller, these touchpanels let users manage the Zoom Rooms meeting experience. You can expand touchpanel capabilities to include full featured AV system and room control by adding the new Extron Control for Zoom Rooms App and an Extron IPCP Pro xi control processor. This App works with any Zoom Rooms controller, including the ZRTP Pro Series touchpanels, to add powerful and fully customizable AV system and room control. Run the ZRTP Pro touchpanel in Zoom Rooms scheduling display mode and it becomes a dynamic room scheduling device, ready to offer easy scheduling options and at-a-glance room occupancy status.

Casey Hall, chief marketing officer for Extron says their new ZRTP Pro touchpanels make it easy to add conferencing, control, and room scheduling to more spaces than ever before. The combination of the

Extron Control for Zoom Rooms App and any Zoom Rooms controller takes control integration to the next level.

ZRTP Pro Series touchpanels and the Extron Control for Zoom Rooms App enable the deployment of the familiar, easy-to-use Zoom collaboration experience combined with the power of Extron control. They work together to create a fully integrated conference and control solution. Now, from the same easy-to-use interface, you can host a video conference and simply tap the screen for full control of lighting, shades, display power, cameras, and more. When used for Zoom Rooms scheduling, the ZRTP Pro Series can be used for any space. Run the touchpanels in the Zoom Rooms scheduling display mode and place them outside of a conference room for room reservations and at-a-glance room occupancy status.

For more information on the ZRTP Pro Series touchpanels and the Extron Control for Zoom Rooms App, [click here](#).

Extron

AMX Introduces AMX MUSE Automation Platform and Four New Controllers



Harman Professional Solutions, a global leader in audio, video, lighting and control, today announced its new AMX MUSE Automation Platform, four new MUSE Automation Controllers, and several supporting developer resources.

Like no other automation platform on the market, AMX MUSE tears down traditional barriers to AV control ingenuity. The MUSE Automation Controller family features powerful, secure, and reliable devices that provide a dedicated computing resource for running the AMX MUSE automation platform. MUSE Controllers can simultaneously process a virtually unlimited number of scripts written in JavaScript, Python, or Groovy and natively support Low-Code development with Node-RED.

Featuring a modern embedded processor that's 10x faster than previous AMX NX Controllers, MUSE Controller models integrate bountiful memory, and rugged, industrial grade eMMC storage. Built on Harman's secure Linux platform, MUSE Controllers are also designed to surpass the requirements of the most secure installations.

Additionally, these Controllers natively support Harman's HControl (open-API), HiQnet (legacy HARMAN audio devices) and ICSP (legacy AMX control devices) protocols, making them the ideal automation processor for any space, environment, or application - old and new.

According to Nick Czaplá, product manager of Harman Professional Video and Control, because of their incredibly loyal and discerning user base, they've had many successes over the decades inventing and re-inventing what control automation should be to push the boundaries of what's possible. While exceeding the needs of users will always be Harman's biggest motivator, the MUSE platform is engineered to equally support the evolving needs of system integrators and developers. Examples include the inclusion of multiple scripting language support and native no-code/low-code programming to support the varying skillsets and language capabilities of developers that will define MUSE possibilities not yet imagined.

Jamie Trader, vice president of Video and Control, Harman Professional Solutions, says that AMX Muse was inspired by the many talented customers and partners he has worked with, who have vastly different skillsets in both programming and non-programming backgrounds. As such, this new platform is a love letter to them, celebrating their diversity, their cleverness, and their deep drive to abandon the constraints of conventional Pro AV. Harman's clients' early reactions have exceeded all expectations, and they couldn't be more thrilled for people to finally experience automation the way they want to have

it: leveraging their tools, supporting their workstreams, and being inspired by all the possibilities that means to them.

Highlights:

*** Multiple Scripting Language Support** - To ensure that AMX MUSE is versatile enough to support a wide range of developers, multiple scripting languages are supported including Python, JavaScript, and Groovy.

*** Native No-Code / Low-Code Programming** - To support No-Code/Low-Code programming, AMX MUSE includes native support for visual flow-based development using the Node-RED development tool.

*** Multiple Simultaneous Script Support** - AMX MUSE Automation Controllers feature a modern embedded processor that's 10x faster than previous AMX NX Controllers to run a nearly unlimited number of scripts simultaneously.

*** Industrial Grade Storage** - To ensure the utmost in reliability, AMX MUSE Automation Controllers include robust, onboard eMMC storage to deliver decades of high-access 24/7 mission-critical operation.

*** Built for the Most Secure Environments** - AMX MUSE Automation Controllers are engineered to surpass the requirements of the most secure environments and are ideal for supporting government, financial, and other applications with ultra-secure needs.

Additional Details

For complete product details and specifications, please visit: [AMX MUSE](#) Automation Controllers Model variations:

- **MU-1000** - ICSLan & PoE
- **MU-1300** - 2 Serial Ports, 2 IR Ports, and 4 I/O Ports
- **MU-2300** - 4 Serial Ports, 4 Relays, 4 IR Ports, 4 I/O Ports & ICSLan
- **MU-3300** - 8 Serial Ports, 8 Relays, 8 IR Ports, 8 I/O Ports & ICSLan

Harman Professional Solutions



From Classroom to Future-Ready Teaching Laboratory - An Inside Look at The Education University of Hong Kong

Teachers enjoy the flexibility to freely move the lectern within the room as it facilitates an active learning environment and the capability to interact with the students



The Teaching Laboratory at EdUHK.

FACTFILE

Project Name: Education University of Hong Kong (EdUHK)

Project Location: Hong Kong, China

Project Segment: Education

Systems Designers and Integrators: BAP

Key AV Solution: Extron

AV Highlight: To meet the challenge of transforming a classroom into a future-ready Teaching Lab that offers complete flexibility for instructors thereby creating an interactive environment.

Key AV Brand: Extron DTP CrossPoint 4K matrix switcher; TLP Pro 725T 7" tabletop touchpanel; Team-Mate portable lectern

The Education University of Hong Kong (EdUHK) is a public research university based in Tai Po, New Territories, Hong Kong. Founded in 1994, it is the only government-funded institute in Hong Kong that specialises in teacher education. The University needed a new E-Learning and teaching laboratory to provide interactive and flexible learning styles in a space designed for students and teachers to explore educational technology tools and resources. The laboratory is designed to foster collaboration, promote innovation in teaching, and develop digital literacy skills.



Another view of the Teaching Lab.

Challenges – Inside and Out

In such a classroom, collaboration is crucial, so it had to be equipped with the latest technology for the delivery of digital lectures and presentations. As such, the designers' wanted the technology to meet today's needs, but also accommodate developments in future teaching technologies.

Outside challenges in planning this new space mainly surrounded the timeline and working up against supply shortages as COVID-19 started impacting the project. Despite these hurdles, clear communication from the integrator, BAP and the Extron team helped set realistic project expectations.

Transforming a Normal Classroom into a Flexible Teaching Laboratory

To create a teaching laboratory, BAP worked with the University to convert a normal classroom with a fixed table at the front and a standard front-throw projector into a flexible space which required a very fluid and easily configurable design. That meant that all the tables, displays, lecterns, and any other items which would find fixed positions in a normal classroom had to be easily and frequently rearranged and, with them, any of the attached AV. As one could imagine, cabling is a huge factor when it comes to moving several pieces of AV equipment from one area to another on a frequent basis. BAP knew that they needed to reduce the overall cable count to make this type of flexible classroom possible.

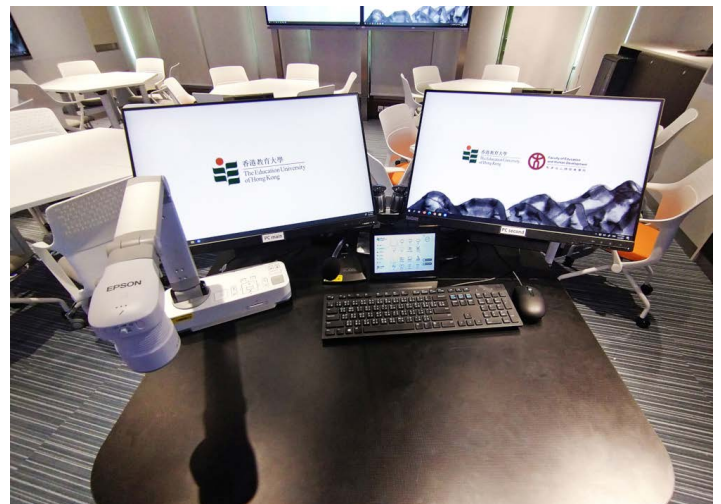

TeamMate Portable Lectern.

Design Solution

The room houses two 85-inch and four 65-inch Fujitsu interactive displays. Supported by an Extron **DTP CrossPoint 4K** matrix switcher with 10 inputs and eight outputs, users can share content freely between these different displays. When they want to select sources, the Extron **TLP Pro 725T** 7" Tabletop Touchpanel on the lectern makes this an easy task. The room is equipped with camera and audio peripherals to enable remote participation using online

meeting tools to support continuity of learning when in-person attendance is not possible. A full-featured, height-adjustable TeamMate lectern delivers a flexible workspace, giving them easy access to their teaching tools and resources.

“The customised and user-friendly TouchLink Pro touchpanel offers intuitive system operation which simplifies control for the instructors,” said Finson Lam, BAP project director.

Because the lectern can be moved to three different locations within the classroom space, there isn't necessarily a “front” of the class. The instructor moves about the room and has access to all the technology they need from the lectern, itself. From various points, they can use the TLP Pro 725T touchpanel and bring up any source and send it to any of the room's six displays.

NAV Pro AV over IP – The Solution the Room Needed

This is where cable consolidation comes into play. Ordinary configurations in a flexible space such as this would involve multiple cables tethered to the lectern and a real challenge when it comes to mobility solution that requires more cables between the endpoint and the matrix, **NAV** manage multiple AV signals over a single 10Gb fibre cable between network switches, which makes the cable management much easier. In this application, the NAV single-fibre solution is ideal - it helps keep the lectern mobile and minimises chances of a wrong cable connection. NAV is also a great choice when it comes to system expansion, which meets another one of the install goals. If it's decided that more monitors are needed, for example, expansion with NAV is as easy as adding two more decoders. If there are ports left on the network switch, NAV can support as much expansion as a space like this will need.

Control and Audio

The customised touchpanel interface includes all of the functionality the instructor needs. Whenever a guest visits and takes over teaching duties, the intuitive nature of the touchpanel and its interface make an easy task out of operating the room AV. The Dante-enabled Extron **DMP 128 Plus** audio DSP processor processes and routes all classroom audio, starting with the lectern-mounted gooseneck microphone for the instructor and Sennheiser ceiling microphone arrays for the students. Audio DSP within the DMP 128 Plus C AT handles dynamics processing, echo cancellation, and auto-mixing, ensuring the cleanest possible audio goes to the **XPA U 358-70V** amplifier, powering **SF 26CT** ceiling speaker that deliver exceptional intelligibility throughout the room.

Results

Education University Hong Kong had its work cut out for them with the timing of their project, but once underway, Extron and BAP worked hard to make it all happen. From the start, it was important to the University to build a sophisticated AV solution but also keep costs in mind. As such, the team was able to use some existing technology, while also bringing in the latest Extron solutions. Working closely with the project team, the end users, and everyone involved, Extron and BAP were able to provide the University with the type of forward-looking technology they desired, while keeping usability high and costs at acceptable levels.

Extron

Türkiye

Türkiye's Culture and Tourism Ministry Selects Anolis for Stunning Maiden's Tower Installation

Anolis fixtures help create beautiful architectural lighting, and a meaningful and educational lightshow that represents the cultural and historical significance of Istanbul



Stunning Lightshow at the Maiden's Tower in Istanbul. Photo by Amanda.

FACTFILE

Project Name: Maiden's Tower

Project Location: Istanbul, Türkiye

Project Segment: Tourism

Systems Designers and Integrators: ASTEL, Asimetrik

AV Highlight: Installation of a permanent lighting scheme that had to be completely watertight and robust

Key AV Brand: Anolis

Istanbul's famous Maiden's Tower, which stands on a tiny islet at the southern entrance of the Bosphorus strait, 200 metres from the coast of Üsküdar in Istanbul, Turkey, has recently re-opened after restoration, complete with a fabulous new permanent lighting scheme designed by Martin Kuhn and featuring over 75 Anolis LED luminaires.

Martin was working for AV specialist ASTEL and end client, the Turkish Ministry of Culture and Tourism. He won a competition to design lighting for the newly renovated monument, also well known for its appearance in the 1998 James Bond Movie, *The World Is Never Enough*.



For the pitch, Martin researched the history of the structure and role in Istanbul's culture and heritage. Parts of the current Tower date back to 1721 CE, although way before then, a wooden tower was likely the first ever construction on the islet as part of a custom ship station around 408 BCE – for vessels coming in from the Black Sea.

He wanted to create a meaningful and educational lightshow that represented the cultural and historical significance of the Maiden's Tower.

The bigger idea with the piece was that visitors could tune in to the narrative in their chosen language via a special website or an App whilst watching the lightshow and have a multi-dimensional experience.

Martin teamed up with one of Turkey's leading authors, Ayse Kulin, who storyboarded a short version which Martin, utilising Depence 3 software, then turned into a 3-minute video showcase for the client.

After successfully winning the job, Martin commissioned musicians and translators for the 8-minute narrative and musical piece and designed and programmed the lighting and visual elements.



From the outset, the show part of the project was designed to be a permanent feature of the tower, and as it was conceived concurrently with the tower renovations, it was totally logical that "permanent" architectural lighting would be part of a broader show solution, so Martin quickly took over this aspect of the design as well.

The result is elegant architectural lighting with the amazing benefit that – through the RGBW colour

mixing – the whites can be “tweaked” to look best on the different surfaces and materials. “A tiny bit of colour had an incredible effect on the walls for example,” elucidates Martin.

The refurbished Tower also needed totally different – and more sustainable – architectural lighting than before.

Martin has designed several significant architectural projects over the last decade, but none of these had required particularly powerful lights or DMX control, so this was his first time utilising Anolis products.

“I was aware of the brand of course,” he said, “and having used Robe lighting fixtures on the various shows I design and knowing them to be reliable and well-made, I was certain that the same standards would apply to Anolis.”



Some of the lighting positions were pre-determined by the building architecture and its position which is just a meter above sea level at high tide and buffeted by waves, blistering sea winds and a generally salty, corrosive environment.

As the architectural scheme emerged, it became a ‘no-brainer’ to re-utilise the previous inground luminaire positions, installing a modern light source, which had to be completely watertight and robust.

After looking extensively at all the available options, Anolis came back as the best choice for its RGBW colour mixing, sustainability, and straightforward DMX control.

“Anolis ticked all the boxes, and I was surprised at how few brands have colour changing and wall washing lights with all this functionality!” Martin noted, adding that he was also impressed with the wide range of optical choices available for Anolis.

With plenty of ambient light to contend with from all over the city, it was essential that the Maiden Tower’s lighting was intense and impactful.

Fifty-six Anolis Eminere 4ft in-grounds are used for the Tower’s base wash, concealed in the battlements around its base, all fitted with 10 x 30-degree optics. They illuminate the Tower “beautifully and evenly,” explained Martin.

On top of the domed metal roof is a ring of 16 x Anolis Calumma S SC’s lighting this area, concealed rigged on a small circular platform just below the roof perimeter, and on the top of the roof, on the highest ring, are 4 x Anolis Calumma S MC 4000’s, shooting up the flagpole.

None of the Anolis fixtures are running at full power as they are so bright!

There are some other flood fixtures in the lighting scheme and the visitor balcony is illuminated with 16 more inground fixtures, and there is a circle of beam moving lights installed around the base which are



hidden in special cabinets in the sea wall remaining closed during the day and these are opened for showtime.

Eighteen lasers in total are involved in the show. Eight projecting lasers are also hidden in similar sea wall compartments, one on a hydraulic lift that elevates to the correct level for delivering show graphics onto the Tower wall after the cabinets are opened.

A further 8 x 50-Watt lasers grace the top of the Tower's roof shooting 360-degree beams around the harbour.

Following the narrative, two 70 Watt lasers - one on the very top of the Maiden's Tower and another installed on the Galata Tower – originally a watchtower 3 kilometres away perched on the highest point of the Walls of Galata in Old Istanbul town's European shore – interact creating a dramatic visual 'bridge' for the show's finale.

Control for the architectural installation and the show lighting is via a grandMA3 replay unit running grandMA3 software which was programmed by Marc Marlo Schelesnow, with laser control and programming courtesy of LASERFABRIK from Cologne.

Audiences can see and experience the Maiden's Tower architectural and show lighting from Istanbul's shores, or by boat, and enjoy the lighting spectacle from both European and Asian parts of the city. Uniquely cosmopolitan and vibrant, it is the only city in the world to spread out across two continents!

The show has already proven a big hit with the public, drawing many people to watch the current shows per evening.

The lighting supply and installation was completed by Asimetrik which is also an Anolis distributor in Turkey. Photos by Amanda Holmes.

Photos by Amanda Holmes.

Anolis

Robe

HONG KONG

From Analog to AVOIP

The famed multimedia room at City University of Hong Kong witnesses a technological renaissance



The transformed Multimedia Room at City University of Hong Kong.

FACTFILE

Project Name: City University of Hong Kong

Project Location: Hong Kong, China

Project Segment: Education

Project Lead: Deep Batra, Section Head of Engineering and Design, Computing Services Centre, City University of Hong Kong

Key AV Solution: Crestron, Wyrestorm, QSC, Unilumin, Tascam, Yamaha

AV Highlight: Transformation of the Multimedia Room from analog to AV-Over-IP, thereby allowing for efficient control and management while also affording ease of scalability when needed.



Within the bustling campus of the City University of Hong Kong – a harbinger of academic excellence – lies a space that transcends the ordinary—a space where ideas find voice and visions come to life. The Multimedia Room (MMR), a sanctum of intellectual discourse, has long stood as a beacon of knowledge dissemination; hosting press conferences, seminars, and distinguished visitors from around the world. In past years, the venue has played host to several high-profile events such as Girls’ Rights Youth Conference, Naming Ceremonies, CityU Convocation Inauguration Ceremonies, CityU School of Law Dispute Resolution Conferences in Asia – all of which proved to be pivotal in the qualitative exchange of ideas and forging objective plans for the future in their respective fields.

Yet, behind its illustrious façade, the MMR bore the weight of time; with the facility’s legacy analog AV hardware – a faithful companion for over 15 years that served the needs of countless events during its tenure – exhibiting signs of operational drawbacks and a sheer lack of capacity to keep up with the demands

of modern-day events. The venue which has for long been hailed as the stage for critical discussions and visionary talks; over the years seemed to struggle to meet the demands of a growing audience and the discerning needs of modern AV-IT capabilities due to its ageing audio and video infrastructure.

“The MMR is an iconic space within CityU; and has been the heart of some of the most illustrious events hosted at our campus. However, with legacy analog systems like back-projection screenings and completely analog AV infrastructure, the quality of audio and video was not ideal, per latest trends and needs of the users. The objective was to bring the latest technology to enhance the overall audience-experience, while also providing the convenience to AV back-end staff to support these high-profile events,” shares Deep Batra, Section Head of Engineering and Design, Computing Services Centre, City University of Hong Kong.

Therefore, a profound transformation was not just necessary – it was imperative; and this urgency is exactly what spurred a visionary initiative.

With the view to commission an extensive overhaul of the MMR, Deep informs that the CityU management signed off on a meticulously crafted plan that involved designing and deploying very economical yet very versatile audio and video solutions that would precisely meet the needs of the room, while working seamlessly on AV-Over-IP, thereby allowing for efficient control and management while also affording ease of scalability when needed. The plan also involved instituting a formidable 8x8 matrix backup that would assure much needed redundancy and dependability.

Impressive plan notwithstanding; the sheer scale of work presented a huge challenge for AV professionals to commission the entire overhaul in one go, as arranging for massive amounts of equipment, cabling and program replacement would all take several days at a stretch. “This was next to impossible, as the venue was consistently in use to cater to a variety of events” informs Deep; as he reveals that the complete overhaul of the AV-IT infrastructure at the MMR had to be done methodically in separate phases.

Phase 1 of the overhaul mainly comprised of ensuring a smooth transition from the existing back-projection screening system to now include a comprehensive state-of-the-art COB (Chip On Board) LED Video wall solution

“The existing back-projection was hip 15 years ago. It was the ultimate solution for saving space on the front stage and caused a bit of a wow factor back then. But it was time to let go after reaping its benefits for so long. With the proliferation of LED technologies in the past few years, CityU had already engaged several suppliers to provision large full height LED walls in

various venues including the CityU Subway, Senate Room and many other important spaces; and the impact of these inclusions were strong and evident. Hence, CityU users were already aware of the tentative video wall requirements and what would work best for the MMR space” recounts Deep.

After quite a bit of deliberation, CityU decided to commence the first phase of the overhaul by integrating a full-height LED Wall (4.8m x 2.7m) that was capable of withstanding both water, humidity and general impact (including accidental collision with metallic objects). And to achieve this, the design and integration team chose Unilumin’s industry leading UMini1.56 LED Video Wall with Chip-on-Board technology which had certificates for both IP50 (water-resistance) and IK10 (Shock-proof) was the solution selected. Installation works were completed by Asia Theatre Engineering Ltd after 2 weeks of continuous dismantling and mounting works.

As soon as the new Umini1.56 LED wall was integrated at the MMR, users noticed a seismic difference in quality of display. With a reported brightness of 600cd /m² and viewing angles of 0° to 170°, the viewing experience was noticeably brighter, and crisper, with sharper colour reproduction and better image clarity being noted by users from all sightlines. The integration of the VX1000 video processor from Novastar has reported played a huge role in enhancing the viewing experience at CityU’s MMR, while also allowing for users to adapt the LED wall to several different display layouts with seamless ease; wherein switching from single source to dual source was as easy as pressing one button on touchpanel.

Speaking about the sheer difference brought about by the newly installed LED video wall, Deep exclaims, “After the installation works and all things considered, it is safe to say, now, the display system is very robust

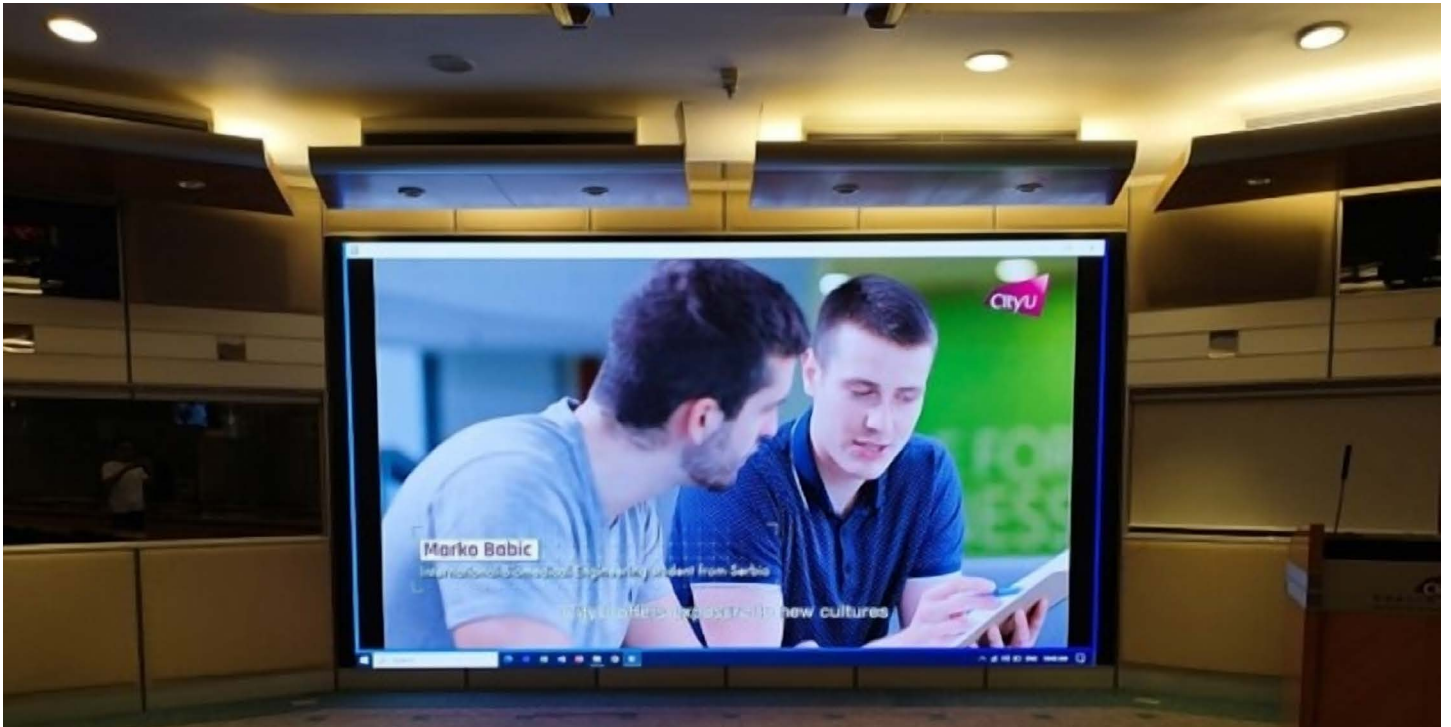

The Unilumin Umini1.56 LED video wall with COB technology now plays a central role as the visual display.

and has literally elevated the entire experience for the audience as well as the users i.e. our control room staff!"

Moving on to phase 2 of the overhaul; and this mainly comprised the integration of new professional audio equipment that could work seamlessly with and leverage the existing infrastructure.

CityU's MMR already featured an existing loudspeaker system from reputed manufacturers JBL which was installed in the control room and at the venue itself. While the loudspeaker system by itself consistently lived up to performance expectations, the CityU management desired to integrate a comprehensive high-performance audio architecture that could function seamlessly with Audio Over IP. Doing so was challenging to say the least, as there were quite a few constraints that needed overcoming. The idea was to introduce quick yet robust fixes that would offer immediate and noticeable differences; and the first

step in achieving this was the deployment of Shure MXCW conference microphones, which proved to be a very quick yet versatile fix to the older UHF based conference microphones that were available at the MMR.

Deep informs, "The use of Shure's MXW jam-free microphones was a no-brainer, where it could simply avoid signal jamming and provide very stable audio quality. Use of networked architecture allowed the team to be as scalable as possible. Whether it was a cozy 10-person press-conference or a 150-person large-conference involving VIPs, the task becomes a breeze and AV staff felt confident to deliver the users' needs."

Furthermore, he explains that in this phase, all audio was transmitted from the receivers to the DSP and Yamaha's TF5 Dante enabled mixer digitally via Dante, and sure enough, no signal degradation or hum noise was noted. It was either a perfect audible sound or

none at all, with all the common problems found in analog systems almost vanishing instantaneously. The Yamaha's TF5 proved to be a vital addition; as the mixer offered the perfect solution to efficiently meet all the current and future needs of the venue – supporting a wide array of options and presets to make sure the audio quality is perfect for conferences or even music performances.

Finally entering into phase 3, which Deep notes to be last stretch of the overhaul as it involved the integration of all the remaining essential components of the AVOIP architecture for the entire technical infrastructure to function as a seamless homogenous system.

Affording an insight into the proceedings of the final phase of the overhaul, Deep informs "With only one shot left, it was a make-or-break case for the AV professionals working on this project. We had to install additional displays and projectors (with projector lifts) around the room, replace all legacy floorboxes, replace existing analog cameras with PTZ tracking cameras from ScanVIS, and replace the old Crestron control system with a brand new one, all the while, ensuring that everything works at the end. Deployment of key solutions from Wyrestorm which included the WyreStorm NHD-110 Encoder/Decoder + Controller along with the EXP-MX-0402-H2 HDMI matrix switcher was the key deal-winner. We had the support from Wyrestorm's Sales Manager, Mr. George Oommen, who ensured that the delivery lead time of all types of extenders never became an issue. We did, however, face a few challenges with the delivery lead times of the control systems from Crestron, which included key products like the Crestron AV4 control processor, the HD-SCALER-HD-E high-definition video scaler, the TS-1070-B-S tabletop touch screens etc. This eventually meant that we had to wait for nearly a year to start the

control system replacement works. Yet, it was a fruitful outcome where we deployed everything on time. We've used Crestron's X-Panel and iPad controls to control all our devices, allowing us to manage all inputs and outputs from over 10 floorboxes around the facility."

In addition to the impressive new AV infrastructure, Deep informs that the MMR has also been outfitted with Milesight's LoRaWan water leakage and temperature sensor around the control room (and all around the campus AV control rooms) to detect potential water leakages and temperature surges, and avoid major disasters. Deep reveals that this system in particular played a key role in saving CityU from "losing millions of dollars" when it alerted the AV-IT management team about a serious water leakage incident caused by various factors including HVAC systems and other structural factors.

In closing, Deep shares his views on the new technological advancements that CityU's iconic MMR now sports, and the kind of impact it has had; as he asserts "It is heartwarming to see many events being organized at the MMR after the venue being refurbished into an international standard venue. The transformation of the MMR has been nothing short of revolutionary; and all the strategic technological enhancements, meticulously executed over the past year, have elevated the very essence of what the MMR stands for. The seamless integration of advanced technologies has transcended the boundaries of what was previous possible; and has now made every single event a safer and more engaging and enriching experience for all!"

City University of Hong Kong

LEARN MORE. EARN MORE.

LEARN from the leaders in audio education
and you'll EARN more respect, more
career opportunities and more
control over your future.



SCAN ME